

EN

CT-DECT Multi M7

with CT-ComLink© SF interface

STANDARD profile

for use as a standard device in a DECT group

Operating manual

Software-Package: S-MULTI-05-001
ProfilSet: PSET-MULTI-STD.NBT.NE-001
Profil: P-MULTI-STD.NBT.NE-001

Contents

1	Safety notices.....	5
2	Introduction	6
3	Applications.....	8
3.1	Application: DECT group consisting of CT-DECT Multi M7	8
3.2	Application: DECT group with CT-DECT Case M7	9
4	Operation	10
4.1	Controls.....	10
4.2	Plug connectors	13
4.2.1	Connecting.....	13
4.2.2	Disconnecting	14
4.3	Power on.....	15
4.4	Power off.....	15
4.5	Muting the microphone.....	15
4.6	Earpiece volume	16
4.7	PTT function.....	17
4.8	Menu control	18
5	Changing the profile	20
6	Menu	22
7	Subscribing DECT.....	23
7.1	Subscribing consecutively.....	24
7.2	Maximum group size	24
8	Internal power supply	25
8.1	Using AAA adapters.....	25
8.2	Changing the batteries / AAA adapters.....	27
8.3	Runtime.....	28
8.4	Battery level monitoring.....	29



8.5	Visual battery status indicator (status LED)	30
8.6	Acoustic battery warning	30
8.7	Automatic shutdown in case of undervoltage.....	31
9	Accessories	32
10	Maintenance and care.....	33
10.1	Inspecting devices.....	33
10.2	Cleaning	33
11	Labeling.....	34
12	Abbreviations and terms	35





1 Safety notices

DANGER

Immediate hazardous situation. Results in death or serious injury.

WARNING

Potentially hazardous situation. May result in death or serious injury.

CAUTION

Potentially hazardous situation with minor or moderate injury.

NOTICE

Indicates a situation that, if not avoided, may cause damage to the product or other property. Used to indicate useful information for efficient and safe use of the product.

Legal notice for operation in the European Union

The transmitter of the CT-DECT device may only be used in the European Union when it has the following label:



2 Introduction

The CT-DECT Multi M7 is a mobile communication device based on DECT radio technology. It enables the user to connect wirelessly to other users in a DECT group.

All participants can talk to each other in full duplex. This means that they can communicate hands-free without pressing a button.

The CT-DECT Multi M7 is used together with a headset.

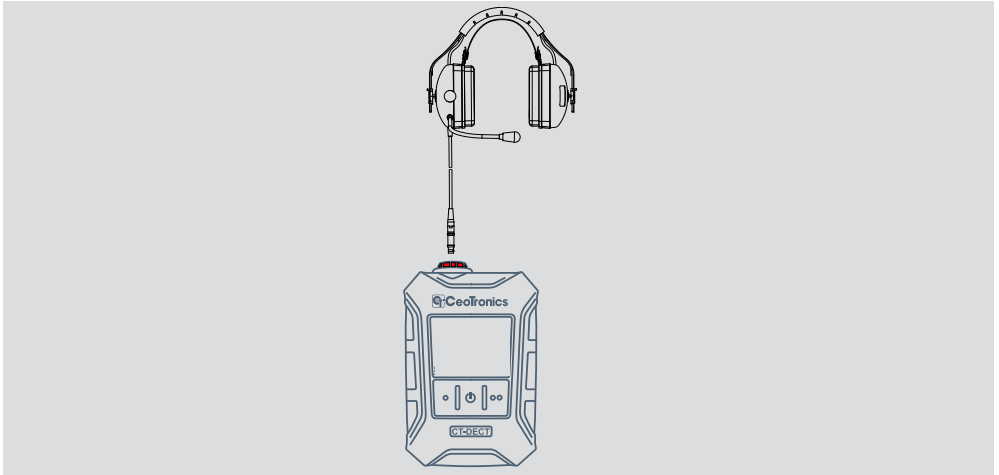

A DECT group always includes a base device, also known as a FixPart (FP), and at least one standard device, also known as a PortablePart (PP).

DECT group with CT-DECT Multi M7

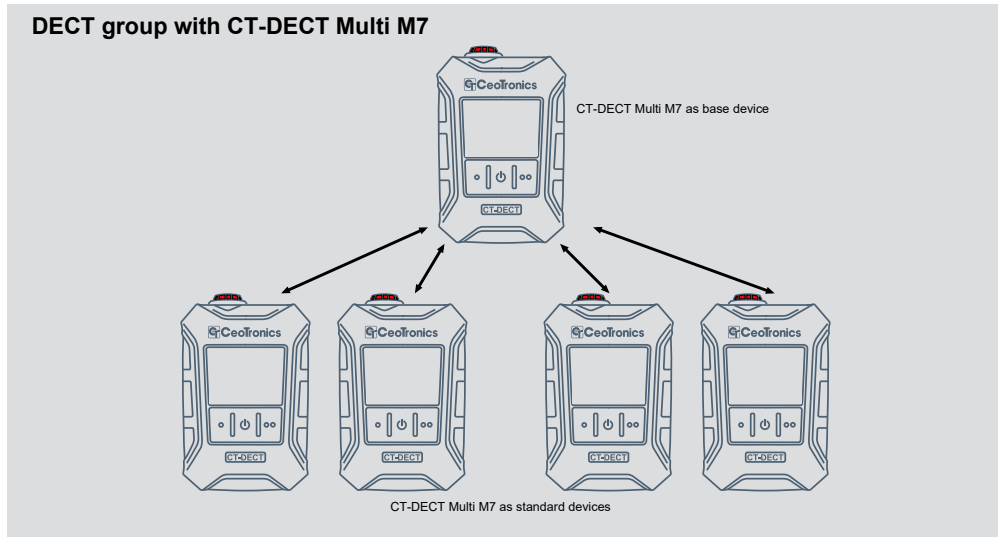

Depending on the software it is equipped with, the CT-DECT Multi M7 offers various profiles made for different use cases and roles.

3 Applications

The CT-DECT-Multi M7 can be used in various application scenarios. Different software profiles can be selected for this purpose.

Only the STANDARD profile is described here.

For information on the use of other profiles, please refer to the corresponding operating manual.

3.1 Application: DECT group consisting of CT-DECT Multi M7

In this scenario, a DECT group consists exclusively of CT-DECT Multi M7.

The devices operating with the STANDARD profile subscribe to the device operating with the BASE profile. This allows DECT groups with up to 5 participants to be formed.

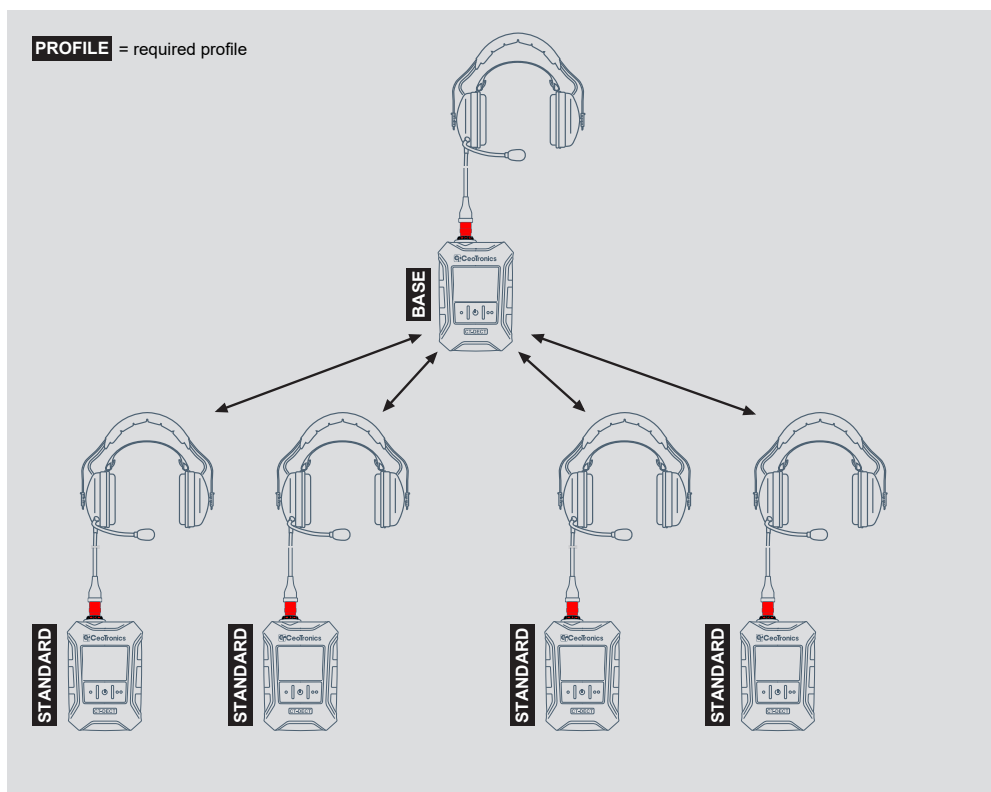

3.2 Application: DECT group with CT-DECT Case M7

In this scenario, the basic device of the DECT group is a CT-DECT Case M7. The CT-DECT Multi M7s operating with the STANDARD profile are subscribed to the CT-DECT Case M7.

This way, DECT groups with up to 12 subscribers can be formed and connected to an external infrastructure.

The following picture shows a sample configuration:

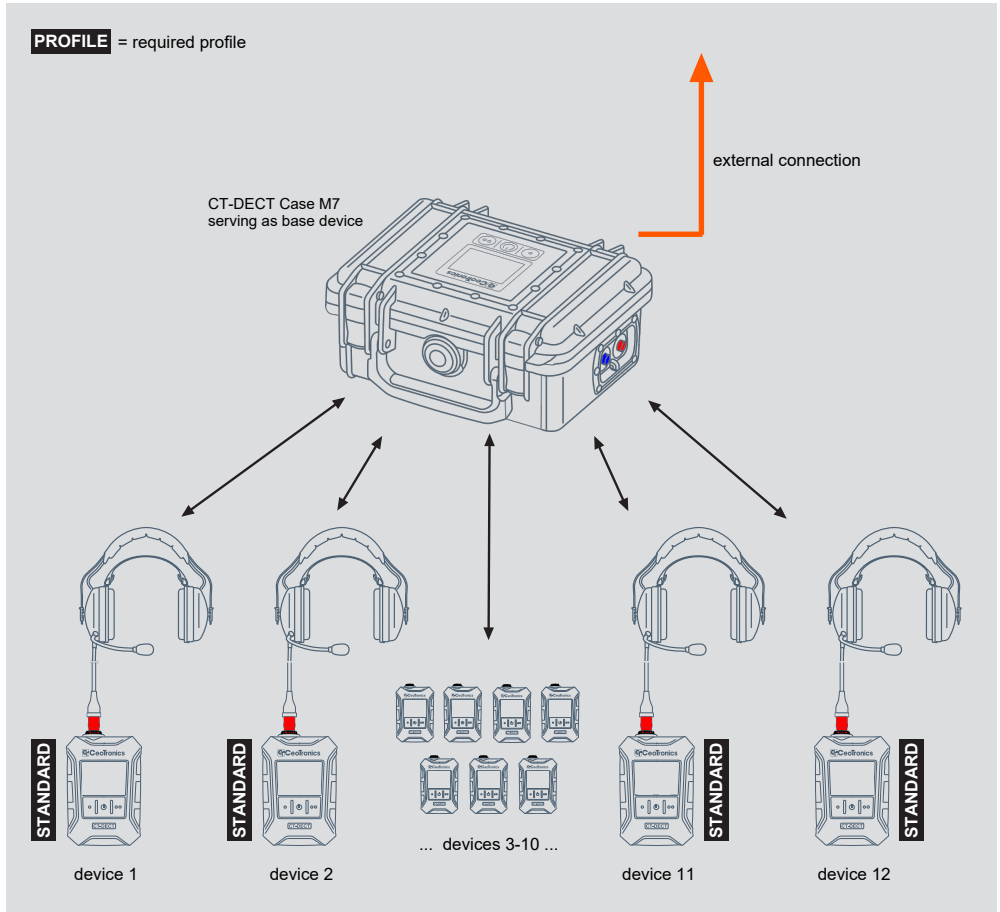

4 Operation

4.1 Controls

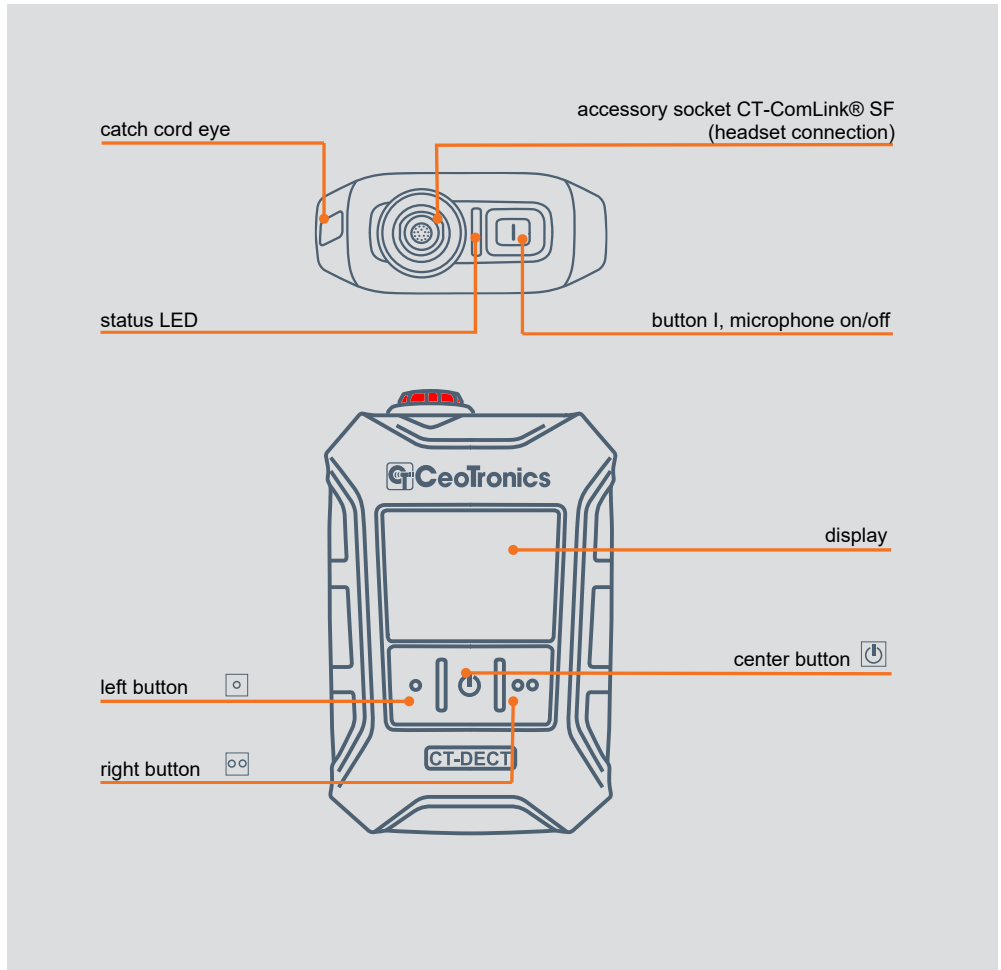

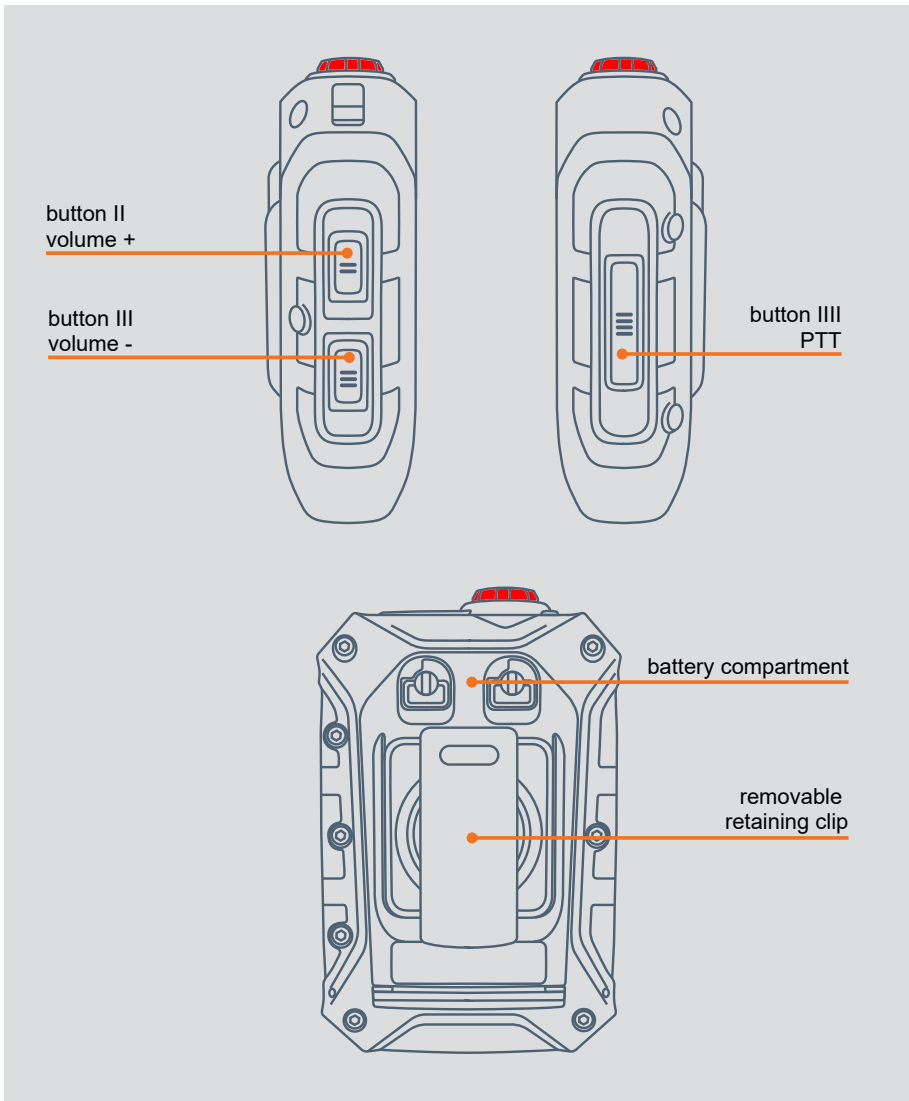

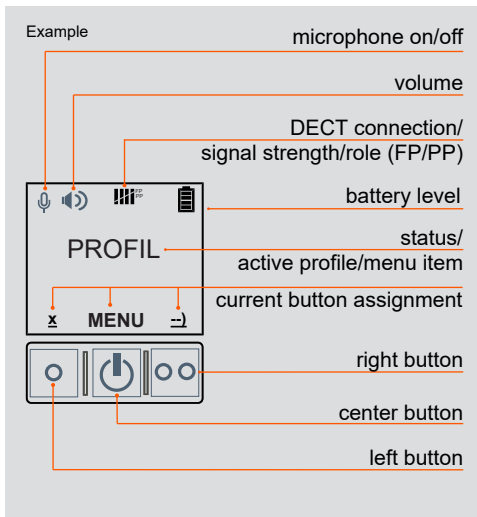

Only displayed
if headset connected.

4.2 Plug connectors

Ensure careful handling of the plug connectors.

4.2.1 Connecting

Step 1

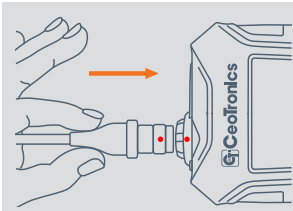

place the plug on the socket. Make sure that the red dots on the plug and socket match.

Step 2

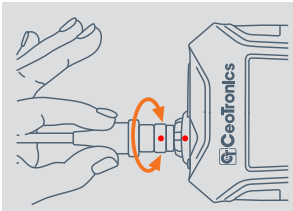

carefully turn the plug on the socket until it slightly slides into the socket.

Step 3

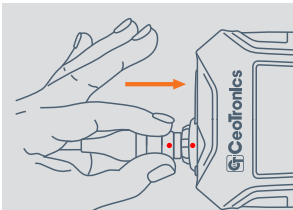

press the plug into the socket until you feel it click into place.

4.2.2 Disconnecting

To release the plug grip it as close as possible to the socket:



Avoid movements as shown in the following illustrations.

NOTICE

Improper handling can damage the connector. The locked connector may neither be twisted nor bent. Never pull on the cable to disconnect the connector.

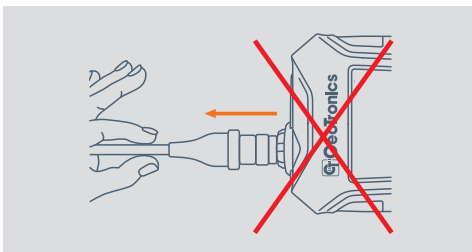
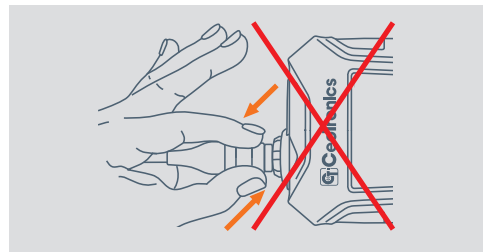
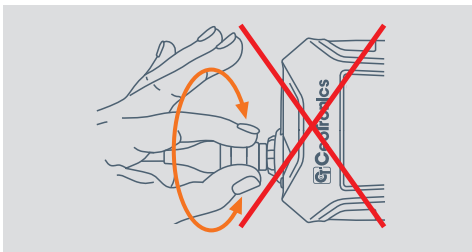

4.3 Power on



Press the center button until the display is active. The currently set profile appears on the display.

4.4 Power off



Press and hold the center button until SHUTDOWN appears on the display - press again to confirm.

4.5 Muting the microphone

By default, the microphone of a connected headset is permanently active/open. This means that other users in the DECT group can always hear you.

If you do not want to be heard all the time, you can mute the microphone.

To mute the microphone of the connected headset, press button I.

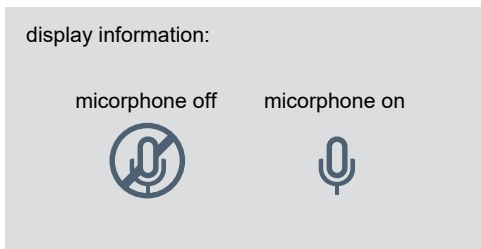
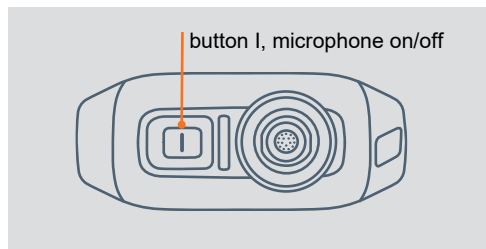

4.6 Earpiece volume

There are 6 volume levels available. They can be selected using buttons II (volume +) and III (volume -). The display shows the volume levels in steps of two. The earpiece volume can be set to the 'off' by holding down button III (volume -) for a longer period of time.

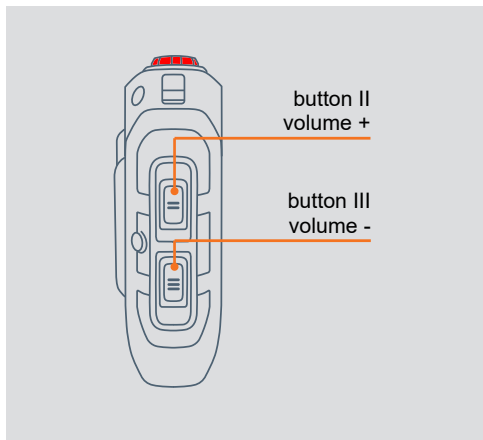

display information:



earpiece off



level 1-2



level 3-4



level 5-6

4.7 PTT function

The PTT button allows you to activate the PTT function of a radio device that is connected to the DECT group.

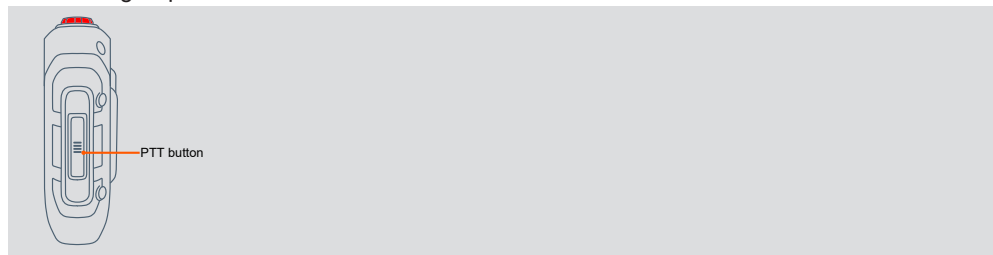

The connection is established, for example, via a CT-DECT Case M7:

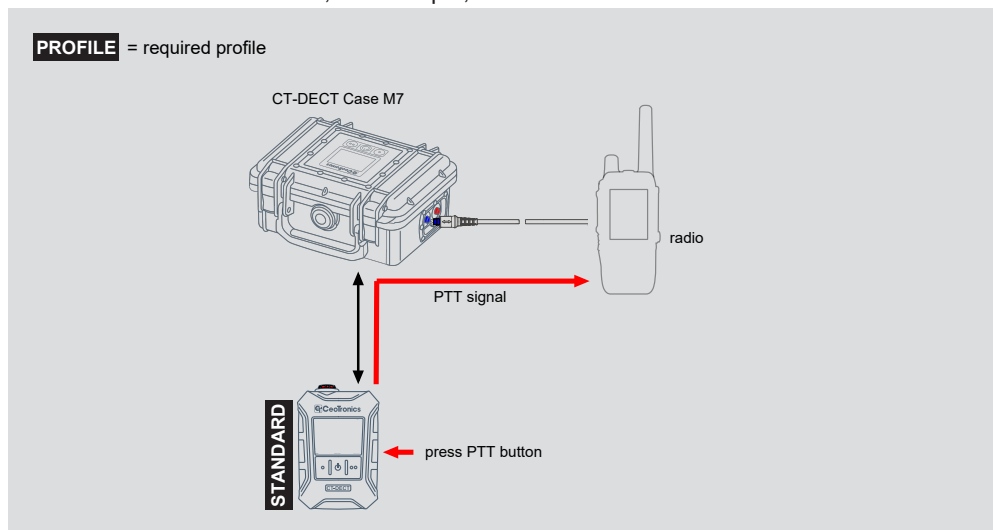

As long as the PTT button is pressed, the user can speak into the radio circuit. Meanwhile, the user continues to hear the DECT group.

NOTICE

If the microphone of the CT-DECT Multi M7 is muted, the PTT function can still be activated. As long as the PTT button remains pressed, the microphone mute function is cancelled.

NOTICE

The behavior of the communication between the DECT group and the radio is strongly dependent on the configuration of the CT-DECT Case M7. See the operating manual of the CT-DECT Case M7 for further information.

4.8 Menu control

Enter menu

Press and hold the center button for 2 seconds to enter the menu.

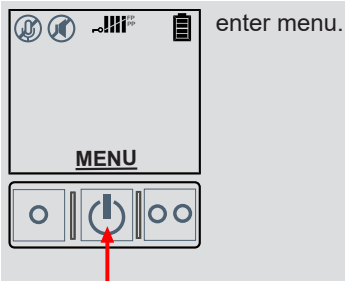

Navigation

Use the three available buttons to navigate through the menu. The corresponding function of the buttons is shown above it on the display.

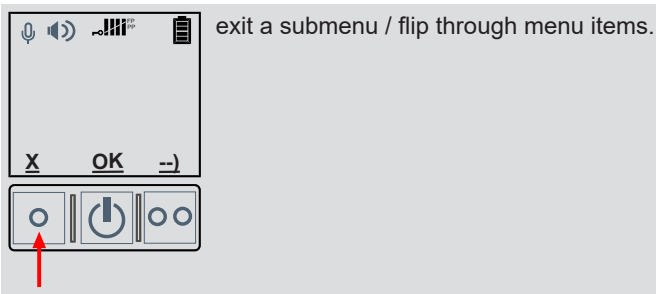
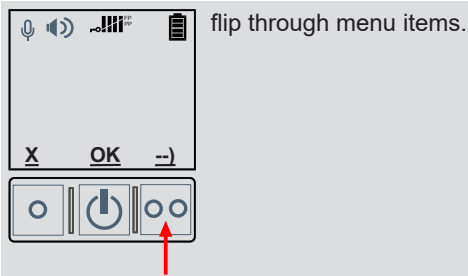

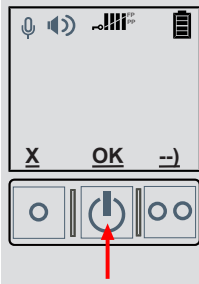

confirm selection.

5 Changing the profile

If the wrong profile is set, you can change it as follows:

1. Power off

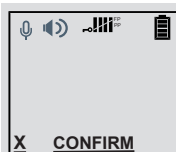

- press and hold the center button until SHUTDOWN appears on the display.



- press the center button one more time to confirm.

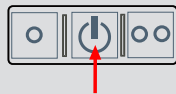

2. Switch on the device and start profile selection



- press and hold the center button and the left button simultaneously until PROFILE appears on the display.



- press the center button one more time to confirm.

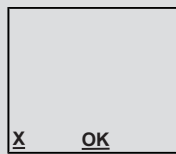

3. Select a profile



- use the right button to flip to the desired profile.

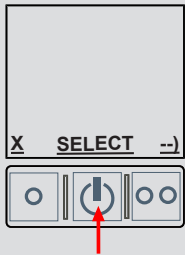

- press the center button to confirm your selection.

4. Confirm the profile change

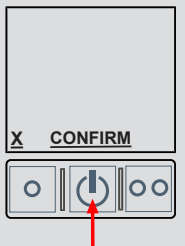

- press the center button one more time to confirm the change.

NOTICE

The device will then restart. All settings are reset.
After a profile change, all previously subscribed CT-DECT Multis M7 must subscribe again.

6 Menu

The following diagram shows all menu items available in BASE profile. Highlighted menu items are only available under certain conditions (see legend).

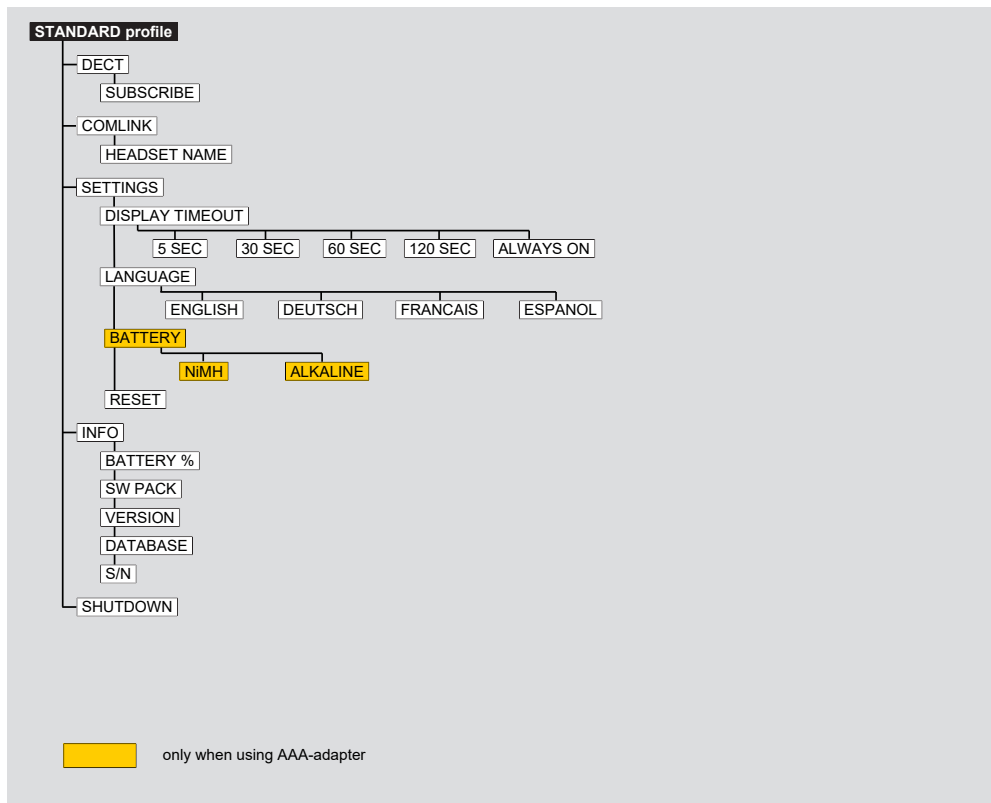

7 Subscribing DECT

Perform the steps quickly one after the other to avoid a timeout.

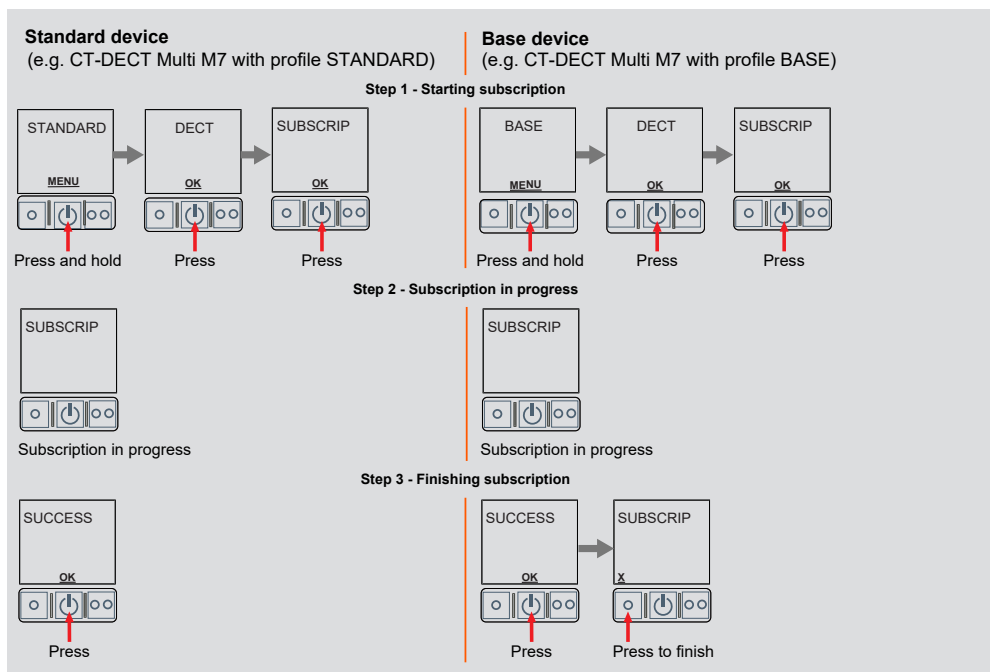

If you want another device to subscribe to the DECT group directly afterwards, see Subscribing consecutively [▶ 24].

NOTICE

Do not switch off already subscribed devices while a subscription process is still running. A switched off device can be overwritten during a new subscription process.

If it is unclear which and/or how many devices have already been subscribed, we recommend deleting all devices subscribed to the base unit via the SETTINGS - RESET menu and restarting the subscription process for all desired devices.

NOTICE

If you want to subscribe several standard devices (PP) to one base device (FP), make sure you only subscribe one device at a time. Do not try to subscribe several devices at the same time.

7.1 Subscribing consecutively

After a successful subscription, further CT-DECT devices can subscribe immediately.

After successful subscription the display in the CT-DECT Case M7 returns to the SUBSCRIPTION menu item ; step 1 on the base station has already been completed and can be skipped.

Continue with step 2 for the next standard device.

7.2 Maximum group size

If a CT-DECT Multi M7 is used as the base device, you can subscribe up to 4 standard devices.

When attempting to subscribe a fifth standard device while all subscribed devices are switched on, the message CONNECTED appears in the base device.

If a fifth standard device is subscribed while a standard device that has already been subscribed is switched off, the switched off standard device is replaced by the newly subscribed standard device.



8 Internal power supply

Power is supplied by VARTA EasyPacks XL (LiPo).

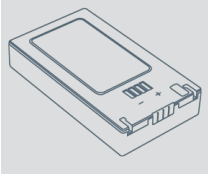

Alternatively, a special AAA adapter filled with three AAA cells can be inserted into the device.

8.1 Using AAA adapters

Instead of a battery pack, special AAA adapter filled with three AAA cells can be inserted into the device.

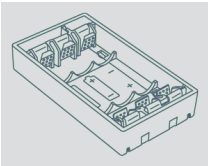

NiMH batteries or alkaline batteries can be used in the AAA adapters. The use of NiMH batteries is recommended.

The runtime depends to a large extent on the types of battery used.

The runtime depends to a large extent on the types of battery used:

- 3 AAA LR03 1.5V alkaline batteries
- 3 AAA HR03 1.2V NiMH batteries



WARNING

Batteries and rechargeable batteries must not be mixed in the AAA adapters. Mixing batteries and rechargeable batteries can result in damage to the device.

NOTICE

Batteries and rechargeable batteries must not be mixed in the AAA adapters. Mixing batteries and rechargeable batteries can result in damage to the device.

Setting the type of battery

For an accurate calculation of the battery level, the device must know the type of battery used in the AAA adapters.

To set the battery type, use the BATTERY menu item:

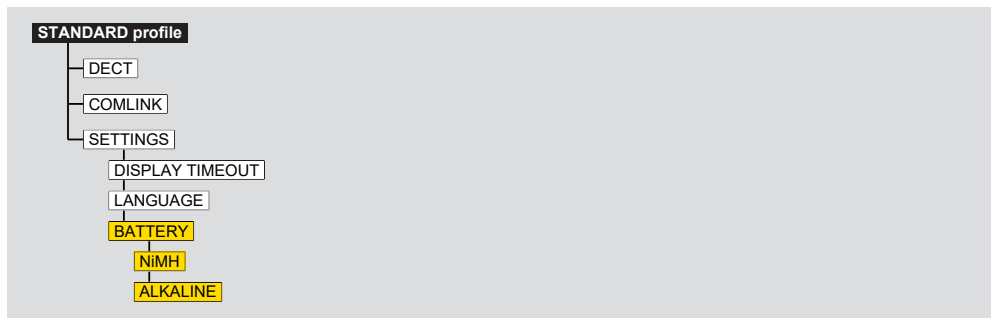

A change is retained even after a restart.

8.2 Changing the batteries / AAA adapters

1. Open the battery compartment

Open the battery compartment by turning the locks clockwise.



2. Change the batteries / AAA adapter

Remove the battery / AAA adapter from the battery department. When reinserting, make sure the electrical contacts of the batteries/battery adapters align with the contacts in the battery compartment.

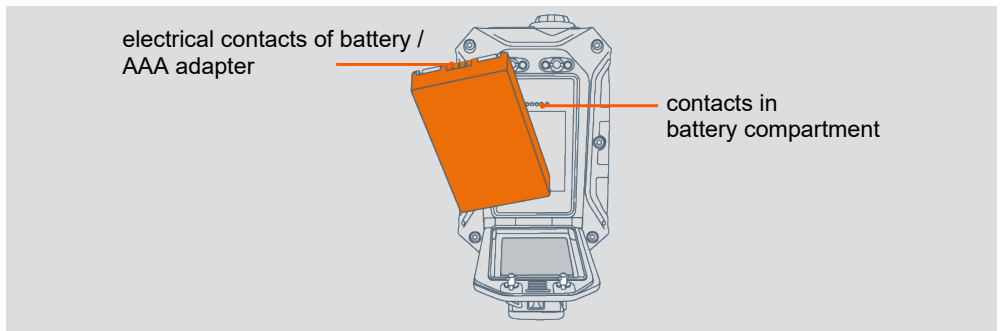

8.3 Runtime

The runtime of the CT-DECT Multi M7 may vary depending on:

- the actual ambient temperature
- the number of connected participants
- the use of the accessory socket
- the intensity of use (transmitting / receiving / standby)

The runtimes in the following table serve only as a rough guide.

Runtimes of the CT-DECT Multi M7 at 20°C

VARTA EasyPack XL	AAA NiMH-Akku Panasonic Eneloop Pro BK-4HCDE (930mAh)
up to 16 hours	up to 8 hours

Runtimes are shorter at lower temperatures. For example, a 10 % drop can be expected at 0 °C compared to 20 °C.

If rechargeable batteries/batteries with different filling levels are used, the runtime may also be shortened.



8.4 Battery level monitoring

Battery levels can be monitored on the display. Simplified icons can be seen permanently at the top of the display.

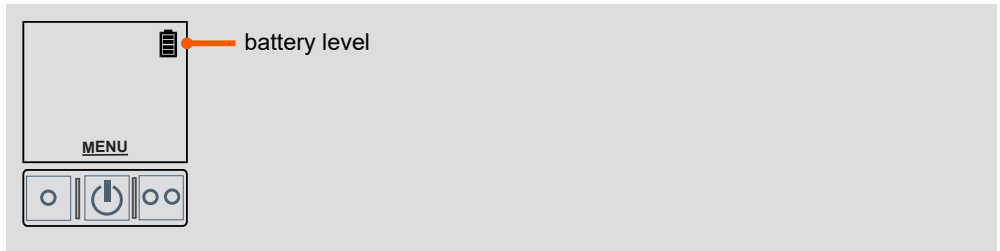

The exact remaining capacity can be called up in the menu.







The battery level calculations are calibrated to the following items:

Description	Short code	Part no
VARTA EasyPack XL LiPo battery pack	AKKU-VARTAEP	4024006
Panasonic eneloop AAA-NiMH battery	AKKU-AAA-ELP	4006504

The use of other types may lead to different results.

8.5 Visual battery status indicator (status LED)

The status LED visually indicates the remaining battery capacity. The assigned values only indicate the estimated remaining battery capacity. They cannot be converted to the remaining runtime without further ado, as this depends considerably on the usage scenario. If the LED flashes red, replace the battery pack/batteries.

	Status LED	Residual capacity
	 green	approx. 34 – 100 %
	 yellow	approx. 10 – 33 %
	 red	approx. 5 – 9 %
	 flashing red (2 sec cycle)	approx. < 5 %
	 flashing red (200 ms cycle)	shutdown imminent

NOTICE

Batteries and rechargeable batteries must not be mixed in the AAA adapters. Mixing batteries and rechargeable batteries can result in damage to the device.

8.6 Acoustic battery warning

When the battery is low, the CT-DECT Multi M7 emits acoustic warnings. These are tones and voice announcements.

State of charge	Acoustic signal / voice announcement	Repetition cycle
0%	BEEP-BEEP – internal battery state – replace battery immediately	30 sec.
undervoltage	BEEP-BEEP – internal battery state – replace battery immediately	10 sec.

8.7 Automatic shutdown in case of undervoltage

To prevent uncontrolled switch-off, the device shuts down automatically if the battery voltage is too low. This switch-off is indicated by the scrolling text UNDERVOLTAGE and a countdown in the display.

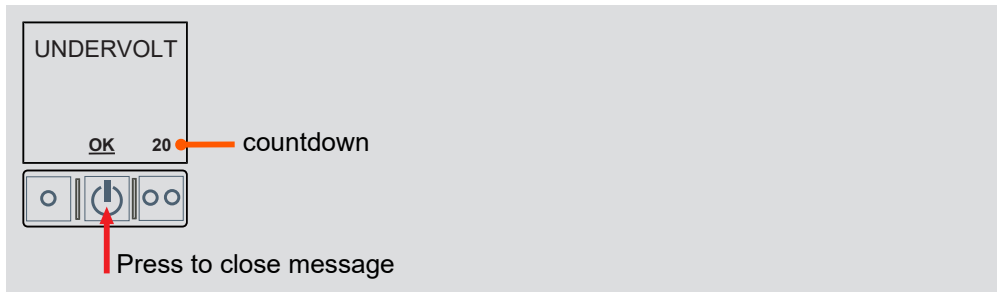

9 Accessories

Description	Short code	Part no
Black bag, for MOLLE systems	TASCHE-MULTIM7	4035141C
Camouflage bag, for MOLLE systems	TASCHE-MULTIM7	4035141-NSN
Orange bag with shoulder strap	TASCHE-MULTIM7	4035150
VARTA EasyPack XL	AKKU-VARTAEP	4024006
Single charging unit for VARTA EasyPack XL	LADE-VARTAEP1	4024008C
4-way battery charger for VARTA EasyPack XL	LADE-VARTAEP4	4024004
AAA adapter for three AAA cells	BATADAP3-AAA	4024005



10 Maintenance and care

10.1 Inspecting devices

Routinely inspect your CeoTronics devices, especially cables and connectors, for damage and wear and have them repaired, if necessary.

10.2 Cleaning

Clean your CeoTronics device with a suitable cloth moistened with clean water. If necessary, you can also use a mild soap solution, e.g. in the form of a hand dishwashing detergent or the following cleaning agents:

- Sterillium® classic pure
- Sterillium® med
- Bacillol® plus

Clean the contacts of the plug connectors with a commercially available contact cleaning agent.

11 Labeling

Outside

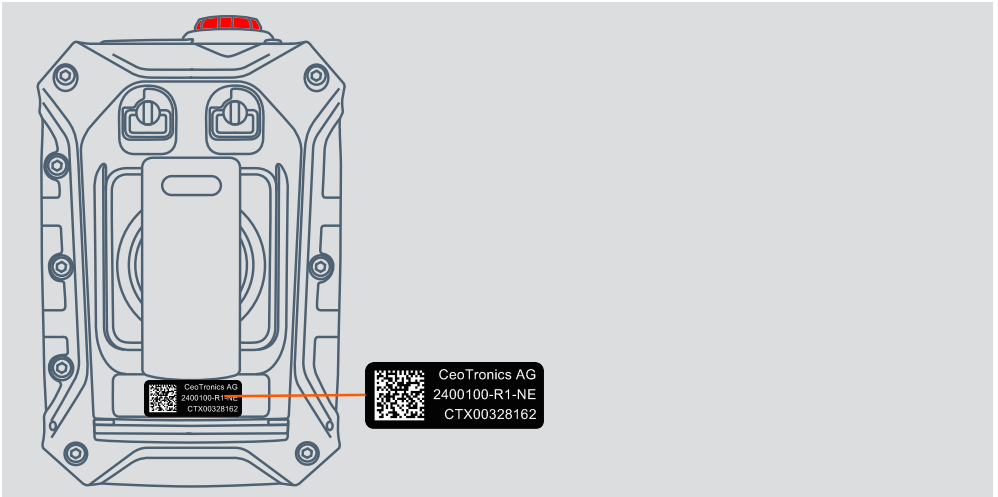

Inside

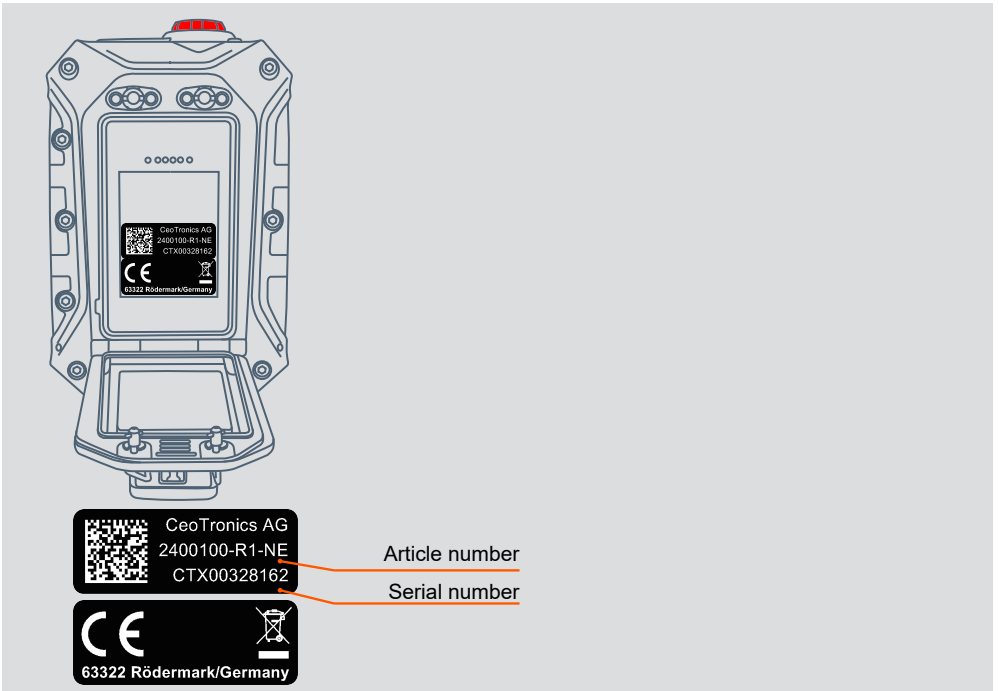

12 Abbreviations and terms

Abbreviation/term	Explanation
AAA	Battery and rechargeable battery size micro
CT-ComLink® SF	SF = Standard mechanical coding „F“ - is usually used to connect a headset
FP	Fixed Part – DECT Basis-Gerät auf das mobile DECT-Teilnehmer (PP) eingelernt werden können
LiPo	Lithium polymer
NiMH	Nickel metal hydride
PP	Portable Part - mobiler DECT-Teilnehmer, der auf DECT Basis-Geräte (FP) eingelernt werden kann
PTT	Push-to-Talk
S/N	Serial number



CeoTronics AG

Audio · Video · Data Communication

Adam-Opel-Str. 6
63322 Rödermark (Deutschland)

Tel: +49 6074 8751-0
Fax: +49 6074 8751-676-265
E-Mail verkauf@ceotronics.com

