

EN

CT-DECT Multi M7

for Plasser und Theurer S-7.5.41C

WIRECOM profile

for use as an interface to a WireCom system

Operating manual

Software-Package: S-MULTI-03-004
ProfilSet: PSET-MULTI-WC.PUT-003
P-MULTI-WC.PUT-001

Contents

1	Safety notices.....	5
2	Introduction	6
3	Applications.....	7
3.1	Application: DECT to WireCom system (e. g. track maintenance machine).....	8
4	Operation	9
4.1	Controls.....	9
4.2	Plug connectors	12
4.2.1	Connecting.....	12
4.2.2	Disconnecting	13
4.3	Power on.....	14
4.3.1	Automatic switch-on.....	14
4.4	Power off.....	15
4.4.1	Automatic switch-off.....	15
4.5	PTT function.....	16
4.6	Menu control	17
5	Changing the profile.....	19
6	Menu	21
7	Subscribing DECT.....	22
7.1	Subscribing consecutively.....	23
7.2	Maximum group size.....	23
8	Internal power supply	24
8.1	Using AAA adapters.....	24
8.2	Changing the batteries / AAA adapters.....	26
8.3	Runtime.....	27
8.4	Battery level monitoring.....	28
8.5	Visual battery status indicator (status LED).....	29



8.6	Automatic shutdown in case of undervoltage.....	30
9	External power supply.....	31
10	Accessories.....	32
11	Maintenance and care.....	33
11.1	Inspecting devices.....	33
11.2	Cleaning.....	33
12	Labeling.....	34
13	Abbreviations and terms.....	35





1 Safety notices

DANGER

Immediate hazardous situation. Results in death or serious injury.

WARNING

Potentially hazardous situation. May result in death or serious injury.

CAUTION

Potentially hazardous situation with minor or moderate injury.

NOTICE

Indicates a situation that, if not avoided, may cause damage to the product or other property. Used to indicate useful information for efficient and safe use of the product.

Legal notice for operation in the European Union

The transmitter of the CT-DECT device may only be used in the European Union when it has the following label:



2 Introduction

The CT-DECT Multi M7 is a mobile communication device based on DECT radio technology. It enables the user to connect wirelessly to other users in a DECT group.

All participants can talk to each other in full duplex. This means that they can communicate hands-free without pressing a button.

A DECT group always includes a base device, also known as a FixPart (FP), and at least one standard device, also known as a PortablePart (PP).

DECT group with CT-DECT Multi M7

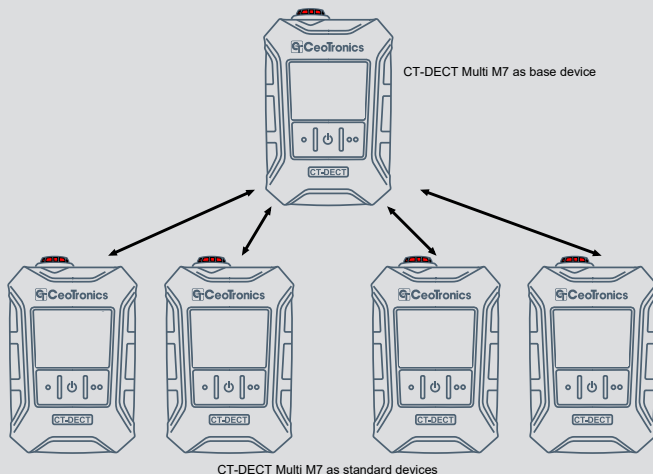

Depending on the software it is equipped with, the CT-DECT Multi M7 offers various profiles made for different use cases and roles.

NOTICE

All DECT devices mentioned in this manual must be approved for use with Plasser & Theurer.

CT-DECT Multi M7s approved for this use are labelled 'S-7.5.41C'.

CT-DECT headsets that are approved for this use are labelled 'S-7.5.42A'.

3 Applications

The CT-DECT-Multi M7 can be used in various application scenarios. Different software profiles can be selected for this purpose.

Only the WIRECOM profile is described here.

For information on the use of other profiles, please refer to the corresponding operating manual.

3.1 Application: DECT to WireCom system (e. g. track maintenance machine)

In this scenario, the CT-DECT Multi M7 used as the base device of the DECT group is connected to the WireCom system using an adapter cable.

This CT-DECT Multi M7 must work with the WIRECOM profile (preset on delivery).

The other devices are subscribed on that device and must work with the STANDARD profile. These standard devices are then connected to other participants that are also connected to the WireCom system.

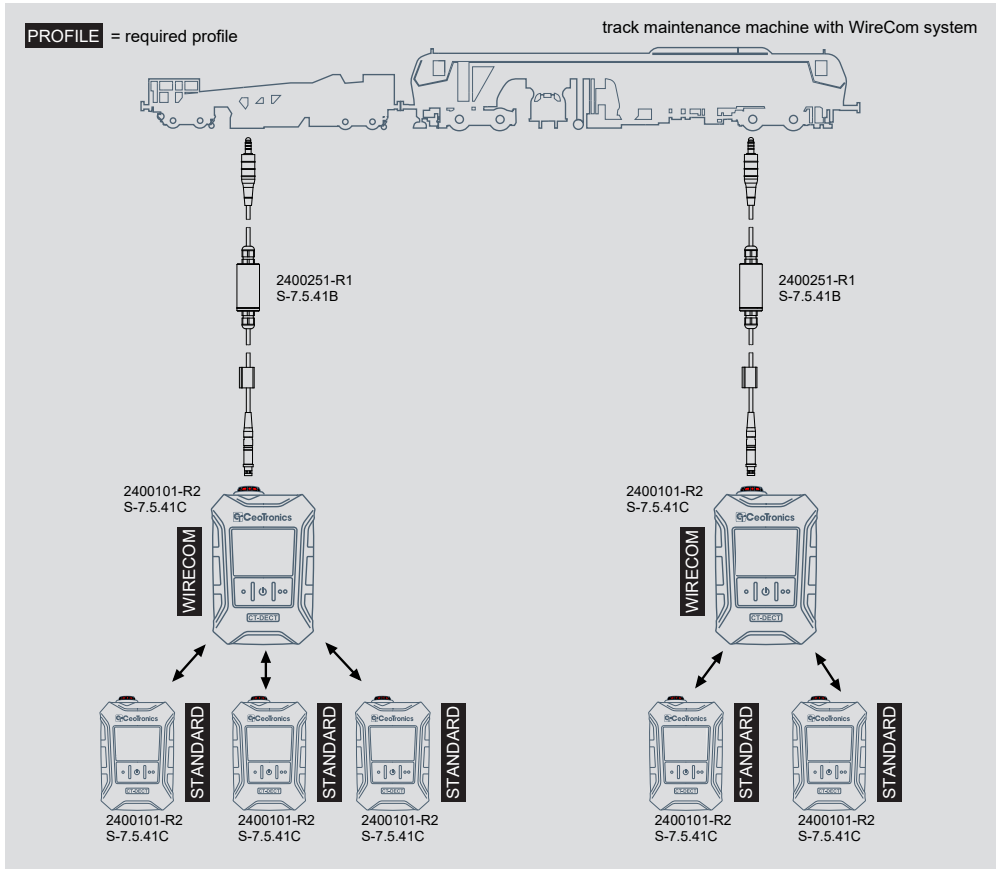

4 Operation

4.1 Controls

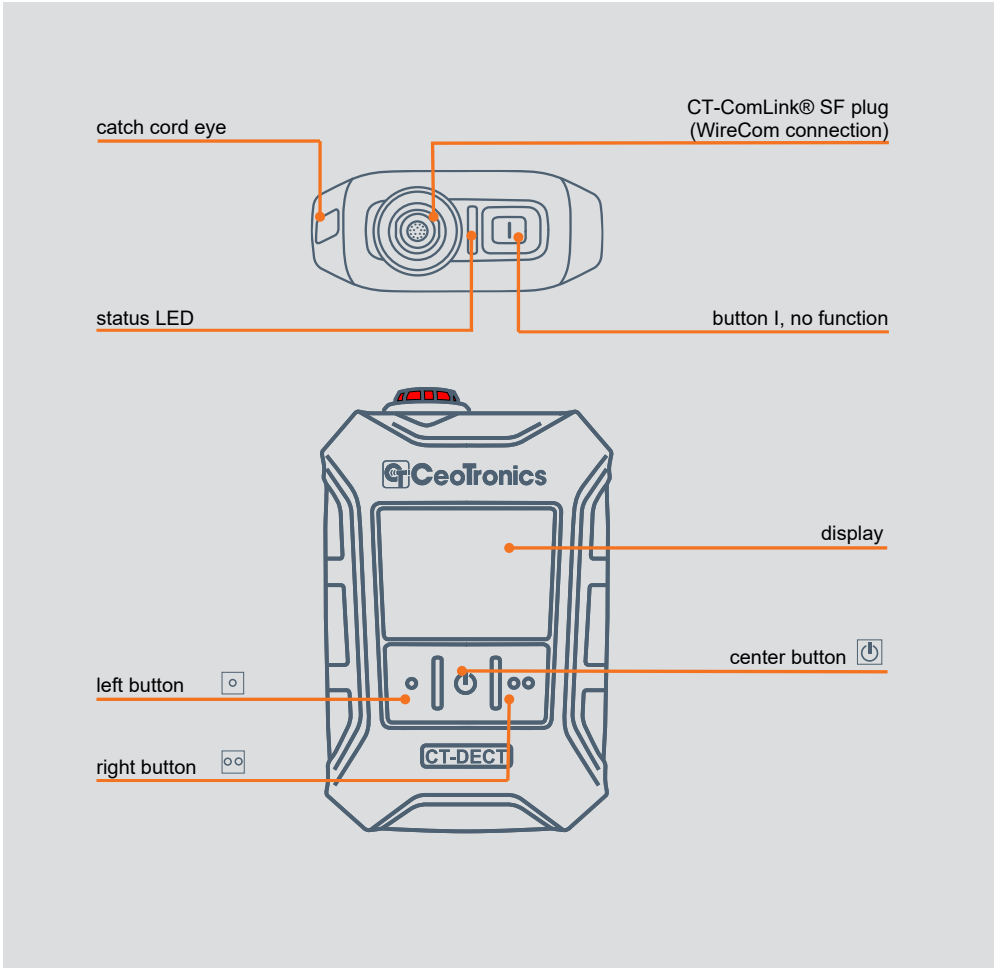

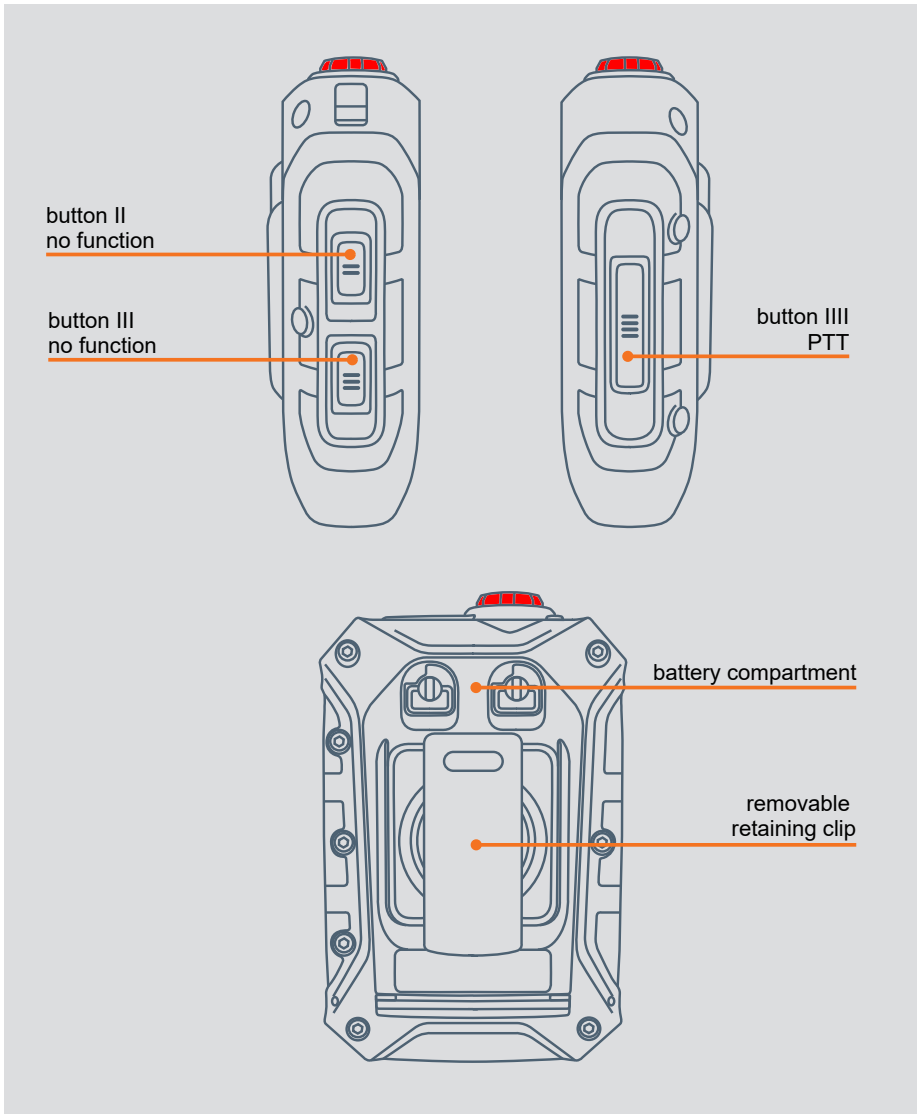

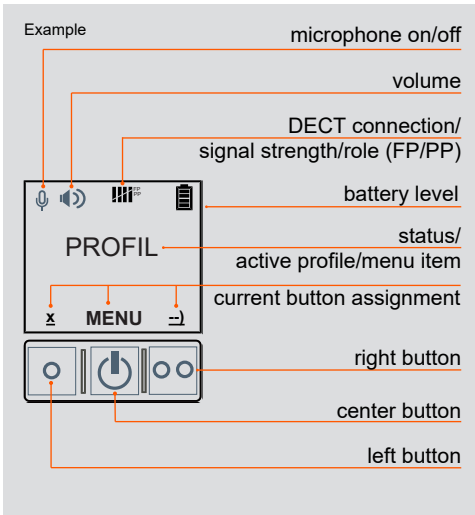

Only displayed
if headset connected.

4.2 Plug connectors

Ensure careful handling of the plug connectors.

4.2.1 Connecting

Step 1

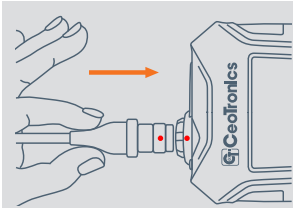

place the plug on the socket. Make sure that the red dots on the plug and socket match.

Step 2

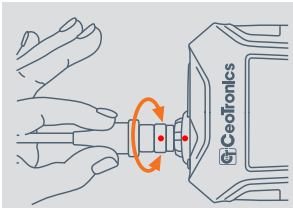

carefully turn the plug on the socket until it slightly slides into the socket.

Step 3

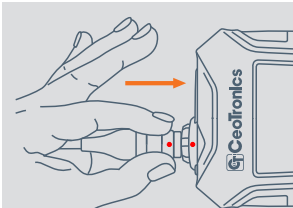

press the plug into the socket until you feel it click into place.

4.2.2 Disconnecting

To release the plug grip it as close as possible to the socket:

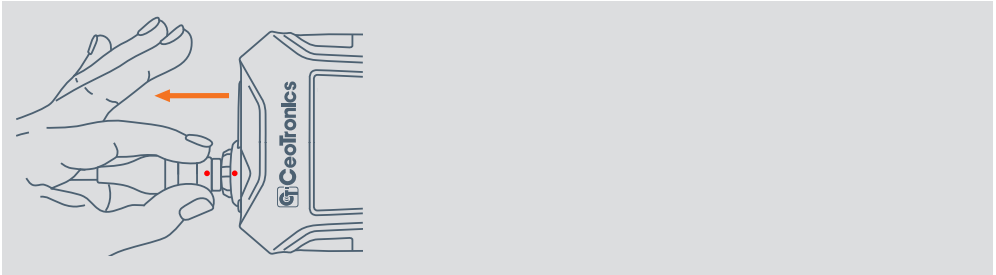

Avoid movements as shown in the following illustrations.

NOTICE

Improper handling can damage the connector. The locked connector may neither be twisted nor bent. Never pull on the cable to disconnect the connector.

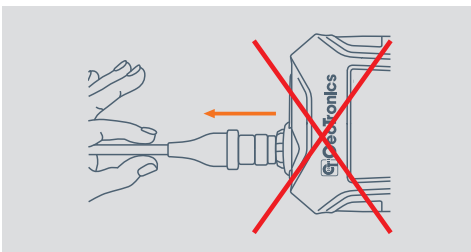
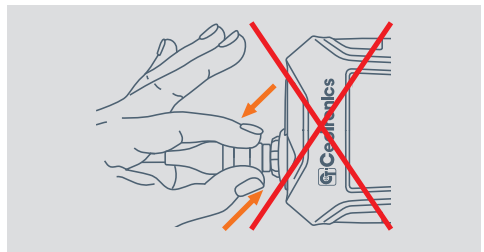
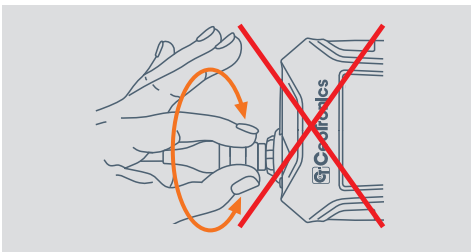

4.3 Power on



Press the center button until the display is active. The currently set profile appears on the display.

4.3.1 Automatic switch-on

If the WireCom system provides a power supply, the CT-DECT Multi M7 is supplied with power via this. The device is automatically switched on when it is connected to the WireCom system.



4.4 Power off



Press and hold the center button until SHUTDOWN appears on the display - press again to confirm.

4.4.1 Automatic switch-off

If the WireCom system provides a power supply, the CT-DECT Multi M7 is supplied with power via this.

If the adapter cable is disconnected from the WireCom system, the CT-DECT Multi M7 starts a countdown for automatic switch-off. This countdown lasts 15 seconds.

The countdown can be ended prematurely and the device switched off by pressing the center button.



end countdown and switch off device

To cancel the countdown, either disconnect the adapter cable from the CT-DECT Multi M7 or press the left button. The device remains switched on and is powered by the internal battery.



cancel countdown

4.5 PTT function

The PTT button allows you to activate the PTT function of a radio device that is integrated in the same WireCom system using the PTT buttons of the CT-DECT group members. Both the device operating as a basic device (WIRECOM profile) and the devices in the group operating as standard devices (STANDARD profile) can use this function.

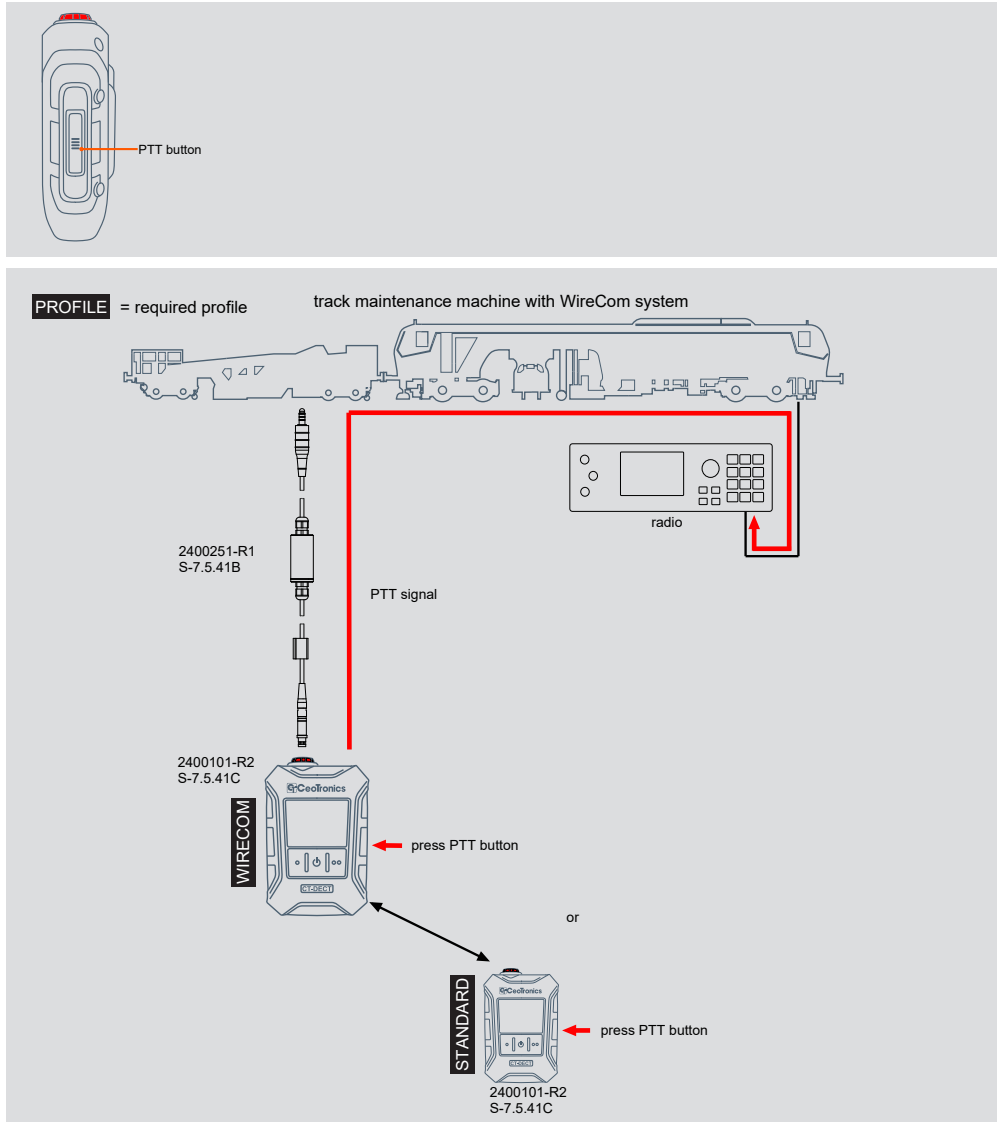

4.6 Menu control

Enter menu

Press and hold the center button for 2 seconds to enter the menu.

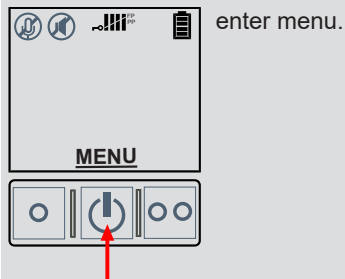

Navigation

Use the three available buttons to navigate through the menu. The corresponding function of the buttons is shown above it on the display.

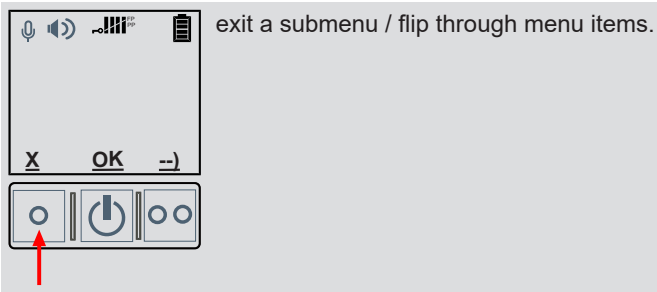
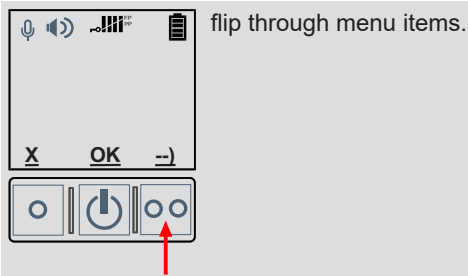



confirm selection.



5 Changing the profile

If the wrong profile is set, you can change it as follows:

1. Power off

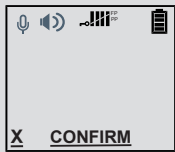

- press and hold the center button until SHUTDOWN appears on the display.

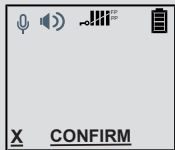
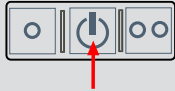

- press the center button one more time to confirm.

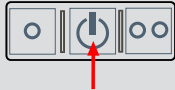

2. Switch on the device and start profile selection



- press and hold the center button and the left button simultaneously until PROFILE appears on the display.

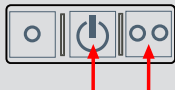

- press the center button one more time to confirm.

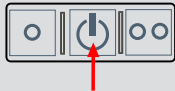
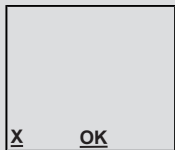

3. Select a profile



- use the right button to flip to the desired profile.



- press the center button to confirm your selection.

4. Confirm the profile change

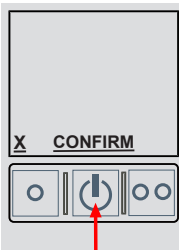

- press the center button one more time to confirm the change.

NOTICE

The device will then restart. All settings are reset.
After a profile change, all previously subscribed CT-DECT Multis M7 must subscribe again.

6 Menu

The following diagram shows all menu items available in WIRECOM profile. Highlighted menu items are only available under certain conditions (see legend).

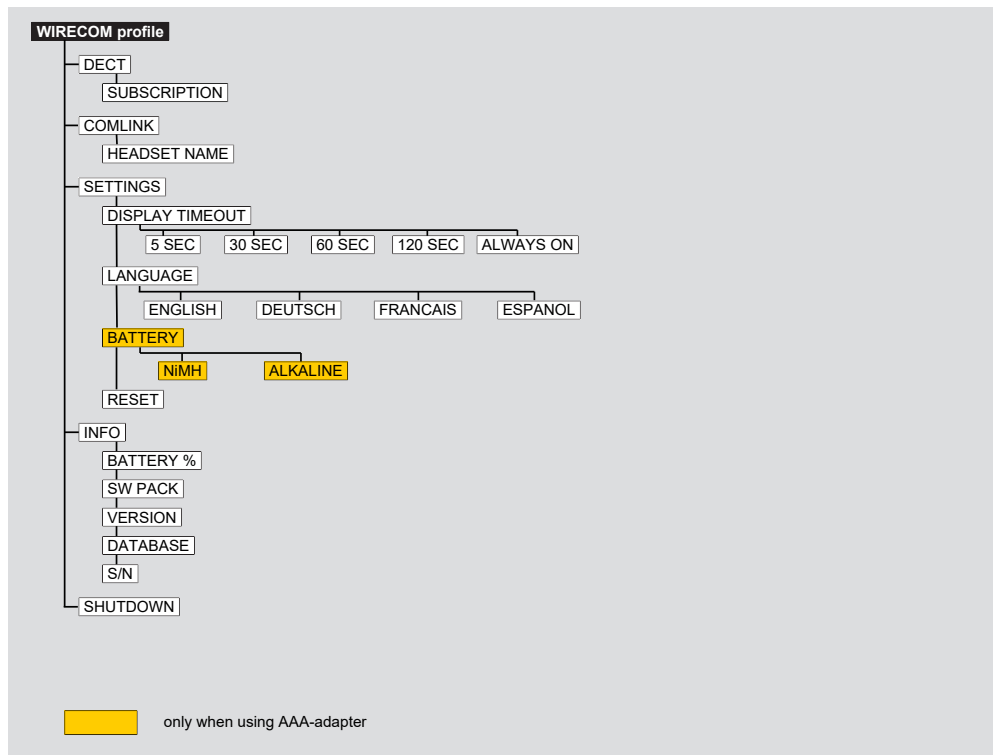

7 Subscribing DECT

Perform the steps quickly one after the other to avoid a timeout.

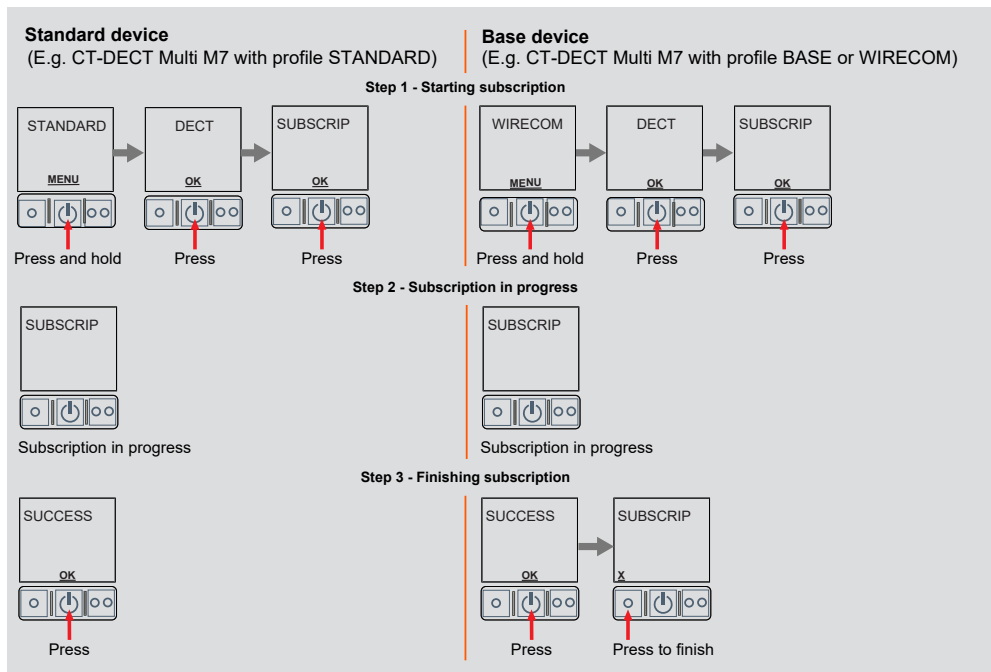

If you want another device to subscribe to the DECT group directly afterwards, see Subscribing consecutively [► 23].

NOTICE

Do not switch off already subscribed devices while a subscription process is still running. A switched off device can be overwritten during a new subscription process.

If it is unclear which and/or how many devices have already been subscribed, we recommend deleting all devices subscribed to the base unit via the SETTINGS - RESET menu and restarting the subscription process for all desired devices.

NOTICE

If you want to subscribe several standard devices (PP) to one base device (FP), make sure you only subscribe one device at a time. Do not try to subscribe several devices at the same time.



7.1 Subscribing consecutively

After a successful subscription, further CT-DECT devices can subscribe immediately.

After successful subscription the display in the CT-DECT Case M7 returns to the SUBSCRIPTION menu item ; step 1 on the base station has already been completed and can be skipped.

Continue with step 2 for the next standard device.

7.2 Maximum group size

If a CT-DECT Multi M7 is used as the base device, you can subscribe up to 4 standard devices.

When attempting to subscribe a fifth standard device while all subscribed devices are switched on, the message CONNECTED appears in the base device.

If a fifth standard device is subscribed while a standard device that has already been subscribed is switched off, the switched off standard device is replaced by the newly subscribed standard device.

8 Internal power supply

Power is supplied by VARTA EasyPacks XL (LiPo).

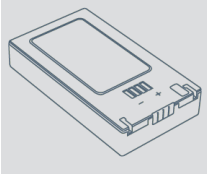

Alternatively, a special AAA adapter filled with three AAA cells can be inserted into the device.

8.1 Using AAA adapters

Instead of a battery pack, special AAA adapter filled with three AAA cells can be inserted into the device.

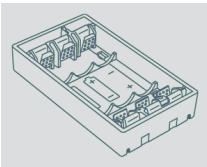

NiMH batteries or alkaline batteries can be used in the AAA adapters. The use of NiMH batteries is recommended.

The runtime depends to a large extent on the types of battery used.

The runtime depends to a large extent on the types of battery used:

- 3 AAA LR03 1.5V alkaline batteries
- 3 AAA HR03 1.2V NiMH batteries



WARNING

Batteries and rechargeable batteries must not be mixed in the AAA adapters. Mixing batteries and rechargeable batteries can result in damage to the device.

NOTICE

Batteries and rechargeable batteries must not be mixed in the AAA adapters. Mixing batteries and rechargeable batteries can result in damage to the device.



Setting the type of battery

For an accurate calculation of the battery level, the device must know the type of battery used in the AAA adapters.

To set the battery type, use the BATTERY menu item:

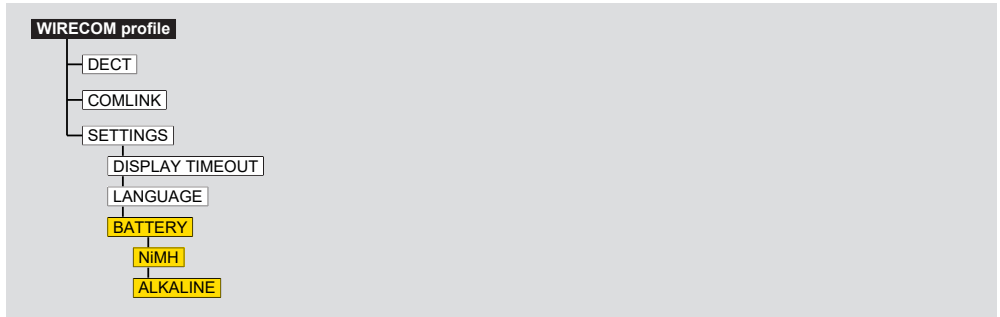

A change is retained even after a restart.

8.2 Changing the batteries / AAA adapters

1. Open the battery compartment

Open the battery compartment by turning the locks clockwise.

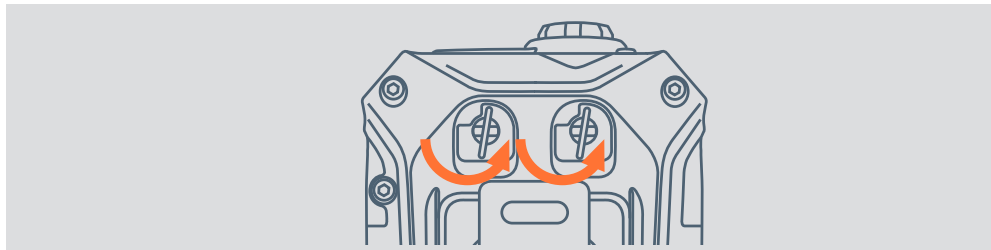

2. Change the batteries / AAA adapter

Remove the battery / AAA adapter from the battery department. When reinserting, make sure the electrical contacts of the batteries/battery adapters align with the contacts in the battery compartment.

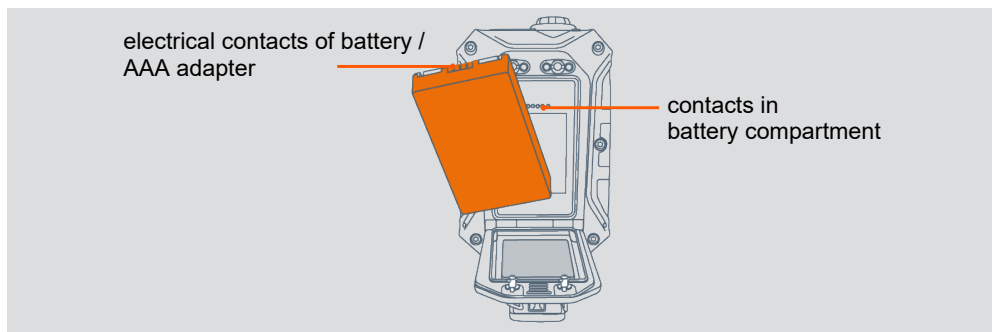

8.3 Runtime

The runtime of the CT-DECT Multi M7 may vary depending on:

- the actual ambient temperature
- the number of connected participants
- the use of the CLR connector
- the intensity of use (transmitting / receiving / standby)

The runtimes in the following table serve only as a rough guide.

Runtimes of the CT-DECT Multi M7 at 20°C

VARTA EasyPack XL	AAA NiMH-Akku Panasonic Eneloop Pro BK-4HCDE (930mAh)
up to 16 hours	up to 8 hours

Runtimes are shorter at lower temperatures. For example, a 10 % drop can be expected at 0 °C compared to 20 °C.

If rechargeable batteries/batteries with different filling levels are used, the runtime may also be shortened.

8.4 Battery level monitoring

Battery levels can be monitored on the display. Simplified icons can be seen permanently at the top of the display.

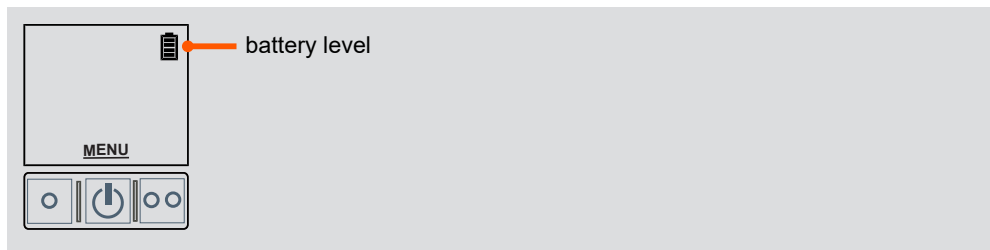

The exact remaining capacity can be called up in the menu.

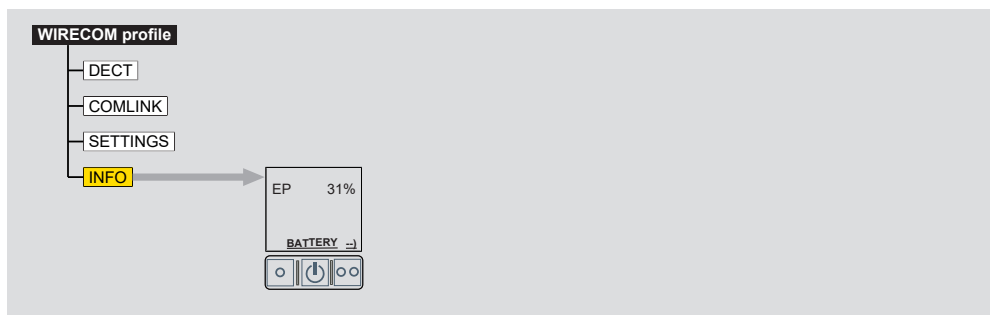







The battery level calculations are calibrated to the following items:

Description	Short code	Part no
VARTA EasyPack XL LiPo battery pack	AKKU-VARTAEP	4024006
Panasonic eneloop AAA-NiMH battery	AKKU-AAA-ELP	4006504

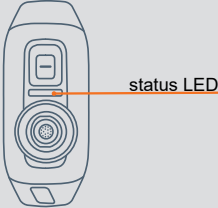
The use of other types may lead to different results.

8.5 Visual battery status indicator (status LED)

The status LED visually indicates the remaining battery capacity. The assigned values only indicate the estimated remaining battery capacity. They cannot be converted to the remaining runtime without further ado, as this depends considerably on the usage scenario. If the LED flashes red, replace the battery pack/batteries.

	Status LED	Residual capacity
	 green	approx. 34 – 100 %
	 yellow	approx. 10 – 33 %
	 red	approx. 5 – 9 %
	 flashing red (2 sec cycle)	approx. < 5 %
	 flashing red (200 ms cycle)	shutdown imminent

NOTICE

Batteries and rechargeable batteries must not be mixed in the AAA adapters. Mixing batteries and rechargeable batteries can result in damage to the device.

8.6 Automatic shutdown in case of undervoltage

To prevent uncontrolled switch-off, the device shuts down automatically if the battery voltage is too low. This switch-off is indicated by the scrolling text UNDERVOLTAGE and a countdown in the display.

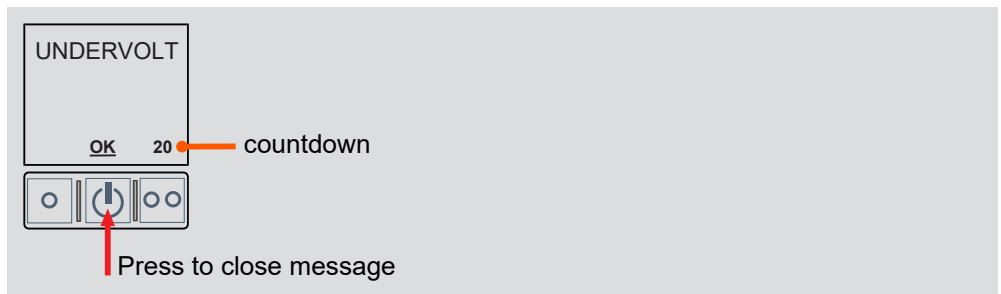

9 External power supply

If the CT-DECT Multi M7 is connected to a WireCom system via an adapter cable, power is also supplied from the WireCom system.

NOTICE

For proper operation, a battery must always be inserted in the CT-DECT Multi M7 - even if power is supplied via the WireCom system at the same time.

10 Accessories

Description	Short code	Part no
Black bag, for MOLLE systems	TASCHE-MULTIM7	4035141C
Camouflage bag, for MOLLE systems	TASCHE-MULTIM7	4035141-NSN
Orange bag with shoulder strap	TASCHE-MULTIM7	4035150
VARTA EasyPack XL	AKKU-VARTAEP	4024006
Single charging unit for VARTA EasyPack XL	LADE-VARTAEP1	4024008C
4-way battery charger for VARTA EasyPack XL	LADE-VARTAEP4	4024004
AAA adapter for three AAA cells	BATADAP3-AAA	4024005



11 Maintenance and care

11.1 Inspecting devices

Routinely inspect your CeoTronics devices, especially cables and connectors, for damage and wear and have them repaired, if necessary.

11.2 Cleaning

Clean your CeoTronics device with a suitable cloth moistened with clean water. If necessary, you can also use a mild soap solution, e.g. in the form of a hand dishwashing detergent or the following cleaning agents:

- Sterillium® classic pure
- Sterillium® med
- Bacillol® plus

Clean the contacts of the plug connectors with a commercially available contact cleaning agent.

12 Labeling

Outside

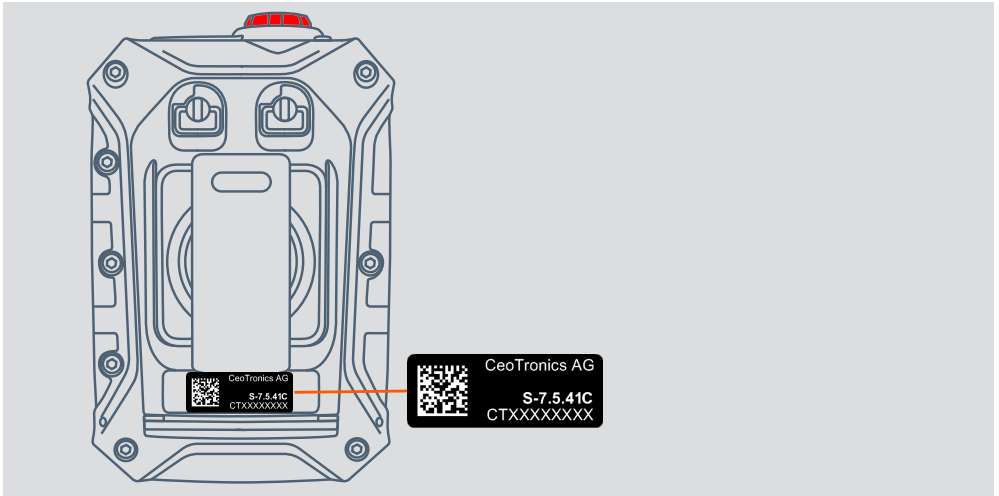

Inside

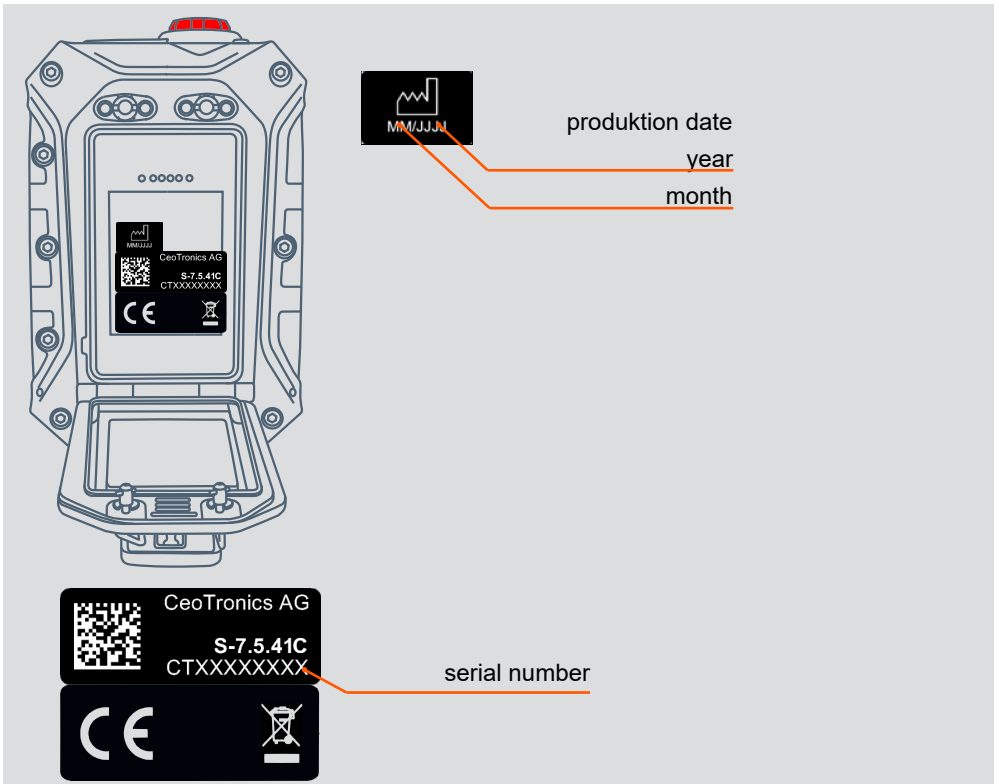

13 Abbreviations and terms

Abbreviation/term	Explanation
AAA	Battery and rechargeable battery size micro
CT-ComLink® SF	SF = Standard mechanical coding „F“ - is usually used to connect a headset
FP	Fixed Part – DECT Basis-Gerät auf das mobile DECT-Teilnehmer (PP) eingelernt werden können
LiPo	Lithium polymer
NiMH	Nickel metal hydride
PP	Portable Part - mobiler DECT-Teilnehmer, der auf DECT Basis-Geräte (FP) eingelernt werden kann
PTT	Push-to-Talk
S/N	Serial number



CeoTronics AG

Audio · Video · Data Communication

Adam-Opel-Str. 6
63322 Rödermark (Deutschland)

Tel: +49 6074 8751-0
Fax: +49 6074 8751-676-265
E-Mail verkauf@ceotronics.com

