

CT-InlinePowerPack

Operating manual

Contents

1	Safety notices.....	4
2	Introduction	5
3	Connection options	6
3.1	Connecting power receivers.....	6
3.2	Connecting an adapter cable	7
4	Operation	8
4.1	Operating elements.....	8
4.2	Insertig or replacing the battery pack / adapter.....	9
4.3	Plug connectors	11
4.3.1	Connecting.....	11
4.3.2	Disconnecting	12
4.4	Connecting	13
4.5	Power on.....	13
5	Accessories.....	14
6	Maintenance and care.....	15
6.1	Inspecting devices.....	15
6.2	Cleaning	15
6.3	Maintenance by the user.....	15
6.3.1	Replacing the seal in the cover.....	15
6.3.2	Replacing the pressure rubbers in the cover	15
7	Abbreviations and terms	16
8	Labeling.....	17



1 Safety notices



DANGER

Immediate hazardous situation. Results in death or serious injury.



WARNING

Potentially hazardous situation. May result in death or serious injury.



CAUTION

Potentially hazardous situation with minor or moderate injury.

NOTICE

Indicates a situation that, if not avoided, may cause damage to the product or other property. Used to indicate useful information for efficient and safe use of the product.

2 Introduction

The CT-InlinePowerPack is a product for supplying power to CEOTRONICS products with a CT-ComLink® interface.
Thanks to the additional CLB socket, the CT-InlinePowerPack can also be used for simultaneous forwarding of a communication signal (e.g. radio).

3 Connection options

3.1 Connecting power receivers

The CLB plug of the CT-InlinePowerPack is used to supply power to CEOTRONICS devices via their CLB socket.

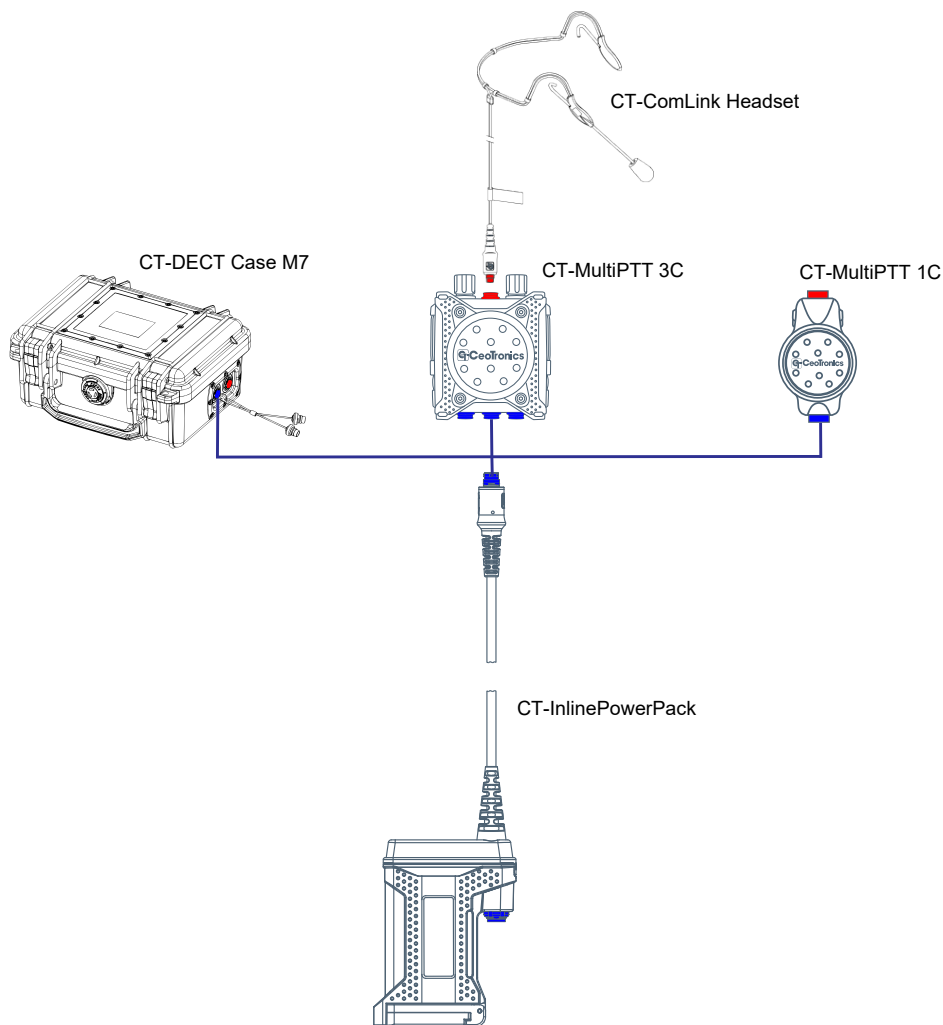

3.2 Connecting an adapter cable

The CT-InlinePowerPack can be used to forward a communication signal simultaneously with the power supply of the connected CEOTRONICS product.

To do this, an adapter cable is connected to the CLB socket of the CT-InlinePowerPack. This adapter cable is then used to connect the CT-InlinePowerPack to e.g. a radio device.

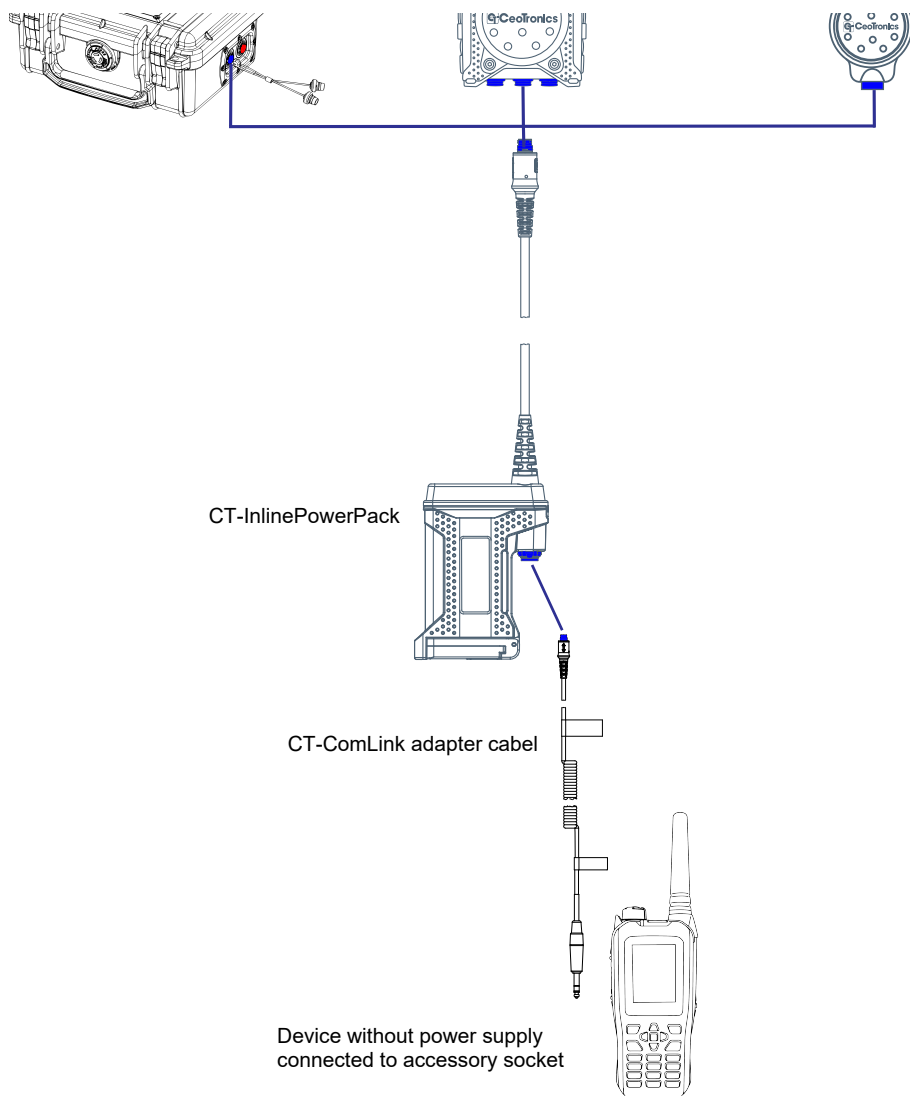

4 Operation

4.1 Operating elements

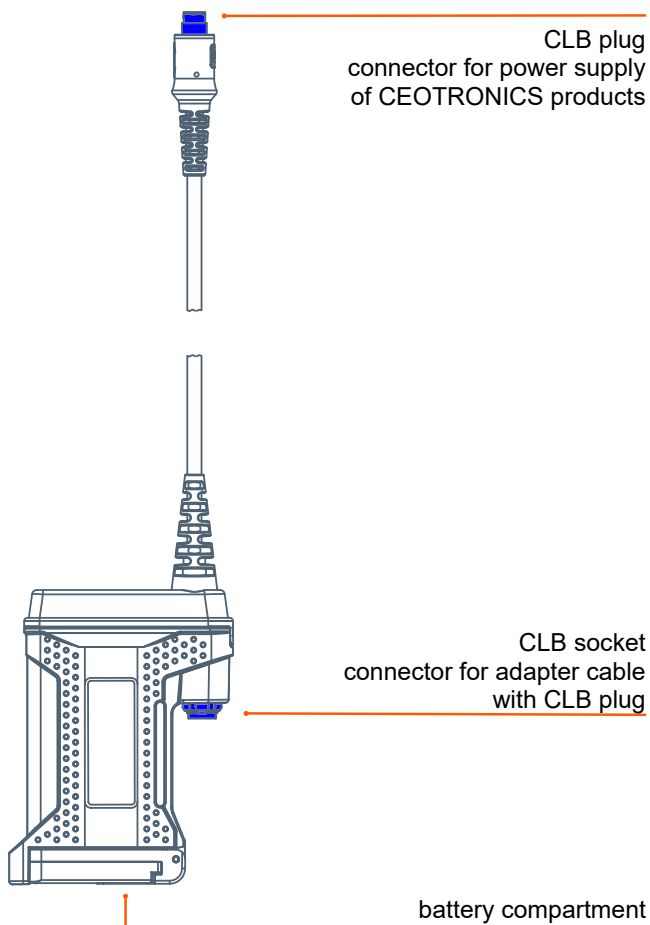

4.2 Inserting or replacing the battery pack / adapter

Both a Varta EasyPack XL and an adapter for AAA cells (rechargeable batteries or batteries) can be inserted into the CT-InlinePowerPack.

NOTICE

When using the adapter, batteries and rechargeable batteries must not be mixed in the adapter.

1. Open the cover of the battery compartment.

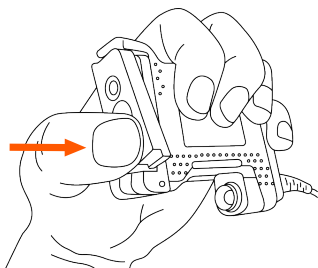

2. When opening the cover, make sure that the opening of the battery compartment is not facing downwards to prevent the battery pack / adapter from falling out.

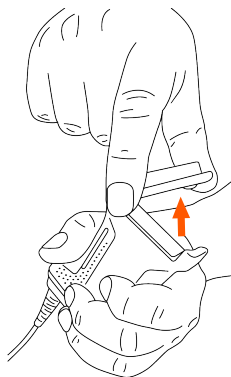

3. Make sure to insert the battery pack / adapter as shown.

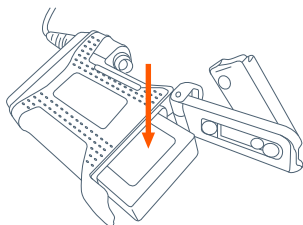

NOTICE

The lid of the battery compartment will be higher than normal if the battery pack / adapter is inserted incorrectly. Do not try to close the lid by applying excessive force. This will damage the device.

Incorrect

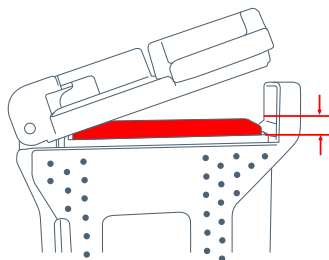

Correct

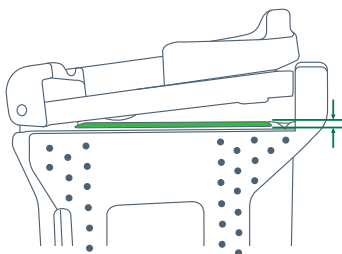

NOTICE

Check the seal when closing. Make sure that the seal is intact. Replace the seal if you notice the following damage:

- Cracks or pressure marks
- Discolouration or build-up on the inside of the cover
- Signs of wear

Further information can be found at "Replacing the seal in the cover" [► 15].

4.3 Plug connectors

Ensure careful handling of the plug connectors.

4.3.1 Connecting

Step 1

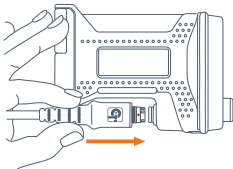

Place the plug on the socket. Make sure that the red dots on the plug and socket match.

Step 2

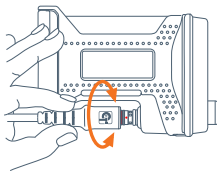

Carefully turn the plug on the socket until it slightly slides into the socket.

Step 3

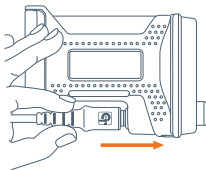

Press the plug into the socket until you feel it click into place.

4.3.2 Disconnecting

To release the plug grip it as close as possible to the socket:

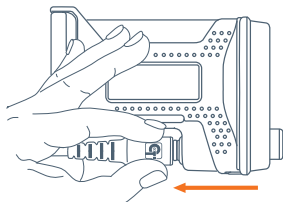

Avoid movements as shown in the following illustrations.

NOTICE

Improper handling can damage the connector. The locked connector may neither be twisted nor bent. Never pull on the cable to disconnect the connector.

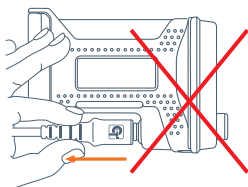
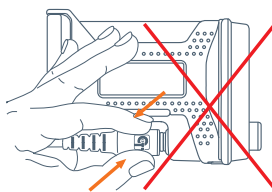
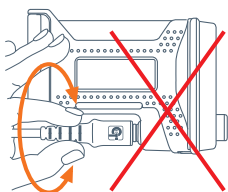

4.4 Connecting

Insert a fully charged battery pack or an adapter containing 3 AAA cells into the device.

Connect the CLB plug of the CT-InlinePowerPack to the CEOTRONICS product to be charged with CLB socket. If required, use an adapter cable to connect an additional radio / intercom to the CLB socket of the CT-InlinePowerPack.



WARNING

Risk of injury from connection leads!

Ensure that the leads do not get caught up in operational machinery or wheels!

4.5 Power on

The CT-InlinePowerPack is switched on and off via the CEOTRONICS product connected to the CLB plug.

Make sure that the connected CEOTRONICS product is switched off when not in use to avoid unnecessary draining of the battery pack / batteries.

5 Accessories

Description	Short code	Part no
Battery pack VARTAEasyPack XL	AKKU-VARTAEP	4024006-ROAD
4-way battery charger for VARTA EasyPack XL	LADE-VARTAEP4	4024004
AAA adapter for three AAA cells	BATADAP3-AAA	4024005
Spare parts for battery compartment cover: <ul style="list-style-type: none">• 2x seal• 10x pressure rubber	ET-APSTK-IPP	6009021

6 Maintenance and care

6.1 Inspecting devices

Inspect your CEOTRONICS devices, especially cables and connectors, regularly for any damage or wear and have them repaired if necessary.

6.2 Cleaning

Clean your CEOTRONICS device with a suitable cloth moistened with clean water. If necessary, you can also use a mild soap solution, e.g. in the form of a hand dishwashing detergent or the following cleaning agents:

- Sterillium® classic pure
- Sterillium® med
- Bacillol® plus

Clean the contacts of the plug connectors with a commercially available contact cleaning agent.

6.3 Maintenance by the user

6.3.1 Replacing the seal in the cover

Remove the old seal without leaving any residue using a suitable tool.

Carefully clean the adhesive surfaces of all adhesions and dirt. Use the cleaning agents specified in the Cleaning [► 15] section.

Insert the new seal precisely and cleanly into the groove.

Close the battery cover to build up the necessary contact pressure for the bonding process.

6.3.2 Replacing the pressure rubbers in the cover

Remove the old pressure rubbers without leaving any residue using a suitable tool.

Carefully clean the adhesive surfaces to remove all adhesions and dirt. To do so, use the cleaning agents specified in the Cleaning [► 15] section.

Remove the protective film from the new pressure rubbers.

Use tweezers to insert the new pressure rubbers into the inside of the cover.

Press the pressure rubbers firmly with your finger and close the battery cover for 24 hours.

7 Abbreviations and terms

Abbreviation/term	Explanation
AAA	Battery and rechargeable battery size micro
CLB	CT-ComLink® B B = blue is usually used to connect a communication device or the CT-InlinePowerPack

8 Labeling

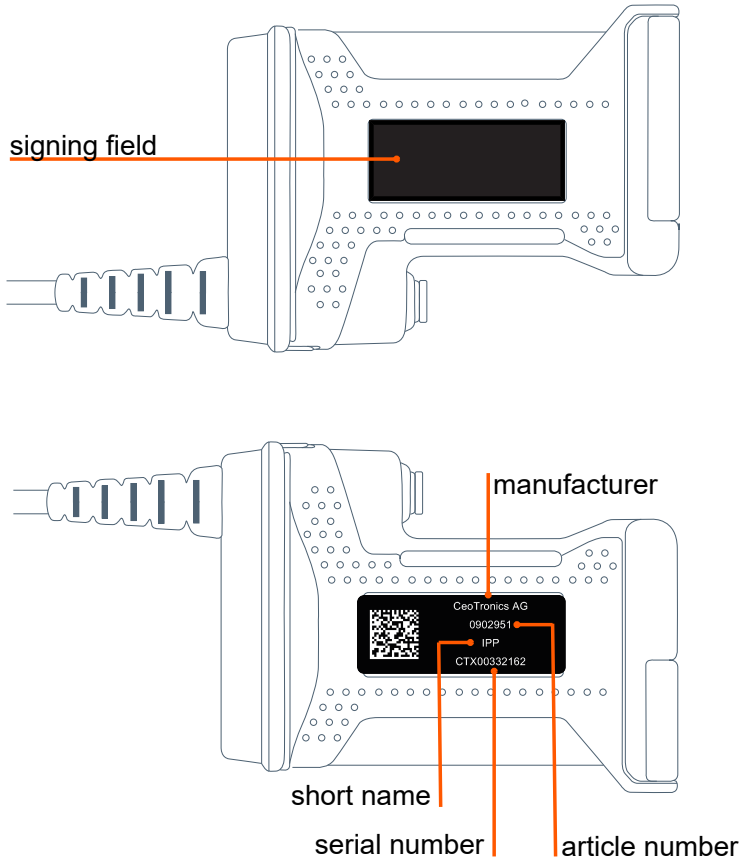

Notes

Notes



CEOTRONICS AG

Adam-Opel-Str. 6
63322 Rödermark (Deutschland)

Tel: +49 6074 8751-0

Fax: +49 6074 8751-676-265

E-Mail verkauf@ceotronics.com